

All drawings are subject to copyright, reproduction only with express permission of Edmund Valve Company (1965) Ltd. Subject to updating and revisions all Edmund valve drawings are product specific. It is the clients responsibility to ensure suitability for service. Materials, design and dimensions subject to contract. MATERIALS TO NACE MR0175 LATEST EDITION (WETTED PARTS).

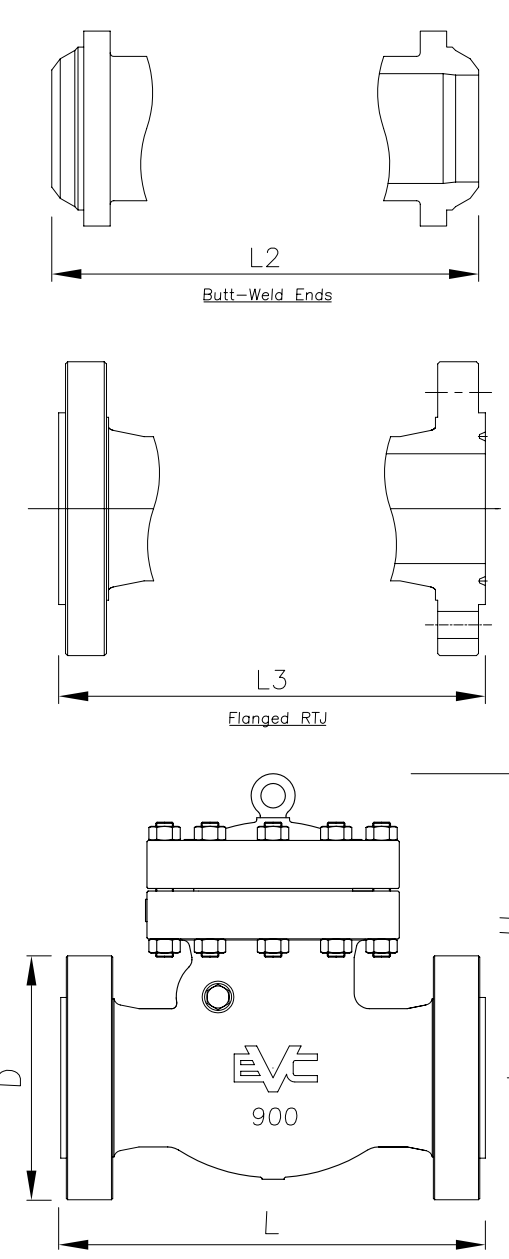
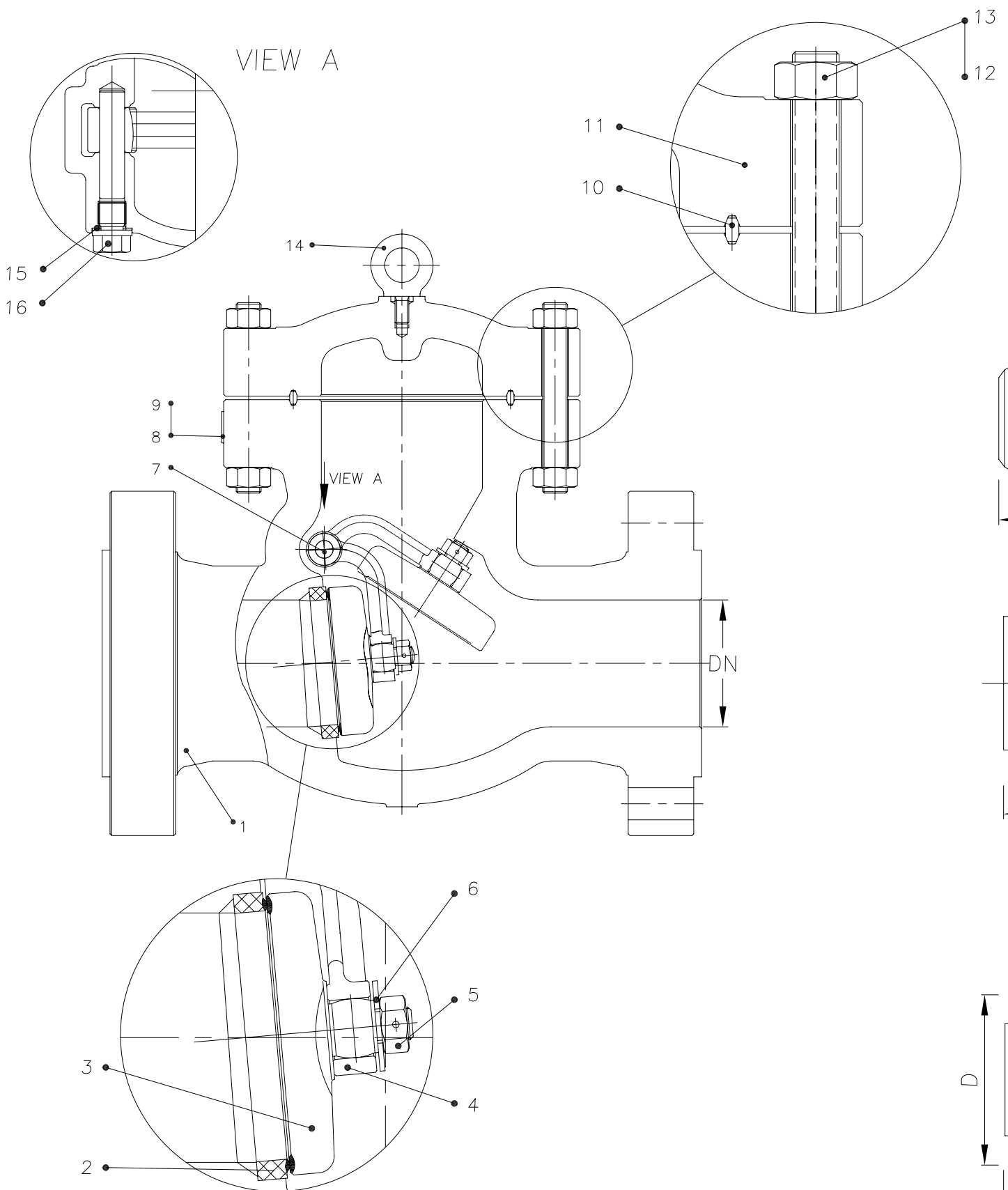

BILL OF MATERIALS

16	Plug	1	A276 410
15	Washer	1	A276 304
14	Eyebolt	1	A29 1035
13	Nut		A194 2H
12	Bolt		A193 B7
11	Bonnet	1	A216 WCB
10	Gasket	1	AISI 304
9	Name Plate	1	304ss
8	Rivet	1	304ss
7	Pin	1	Carbon Steel
6	Washer	1	A276 304
5	Disc Nut	1	A276 410
4	Hinge	1	A216 WCB
3	Disc	1	A216 WCB+Stellite
2	Seat Ring	2	A105+Stellite
1	Body	1	A216 WCB

NO.	Part Name	Qty.	Material
-----	-----------	------	----------

Materials available on request: Stainless steel all grades; Duplex & Super Duplex; Chrome-moly; Inconel; Monel;

N.B	DN	L	L2	L3	D	H	Wgt*
2"	43	368	368	371	216	333	63
3"	66	381	381	384	241	389	99
4"	92	457	457	460	292	419	193
6"	139	610	610	613	381	587	342
8"	182	737	737	740	470	680	562
10"	230	838	838	841	546	756	1035
12"	273	965	965	968	610	1008	1305
14"	300	1029	1029	1038	641	1035	1575
16"	344	1130	1130	1140	705	1067	2178

BW schedule as per client order  
\* Wgt for RF valves only

ENGINEERING DATA

DESIGN CODE	BS 1868/ANSI B16.34	TEST PRESSURES		
FACE TO FACE DIMENSIONS	ASME B16.10	BODY	225.0	Barg
END CONNECTION DIMENSIONS	ASME B16.5 / 16.25	SEAT	165.0	Barg
TESTING CODE	API 598	BACKSEAT	165.0	Barg
		AIR - SEAT	6.0	Barg

BY	CHK	APP	SCALE:
			DRAWN DATE
			CHECKED DATE
			APPROVED DATE

DRAWING TITLE:  
API CAST STEEL CLASS 900  
BOLTED COVER, RF,RTJ,BWE, SWING CHECK VALVE

PROJECT:  
PACKAGE:  
VENDOR DOC.NO.:

CAD. No. DRAWING NUMBER: 120067 REV 00  
TYPICAL ONLY  
AREA No. | FACILITY | TYPE | SEQ. No. | SHT. No.