

BILL OF MATERIALS			
NO.	Part Name	Materials	Materials
6	Bolt	A193 B8(M)	A193 B7(M)
5	Bonnet	A182 F316(L)	A105
4	Gasket	304SS+Graphite	304SS+Graphite
3	Spring	A276 304	A276 304
2	Disc	A182 F316(L)+STL	A276 420+STL
1	Body+Seat*	A182 F316(L)+STL	A105+STL

*: Seat integral

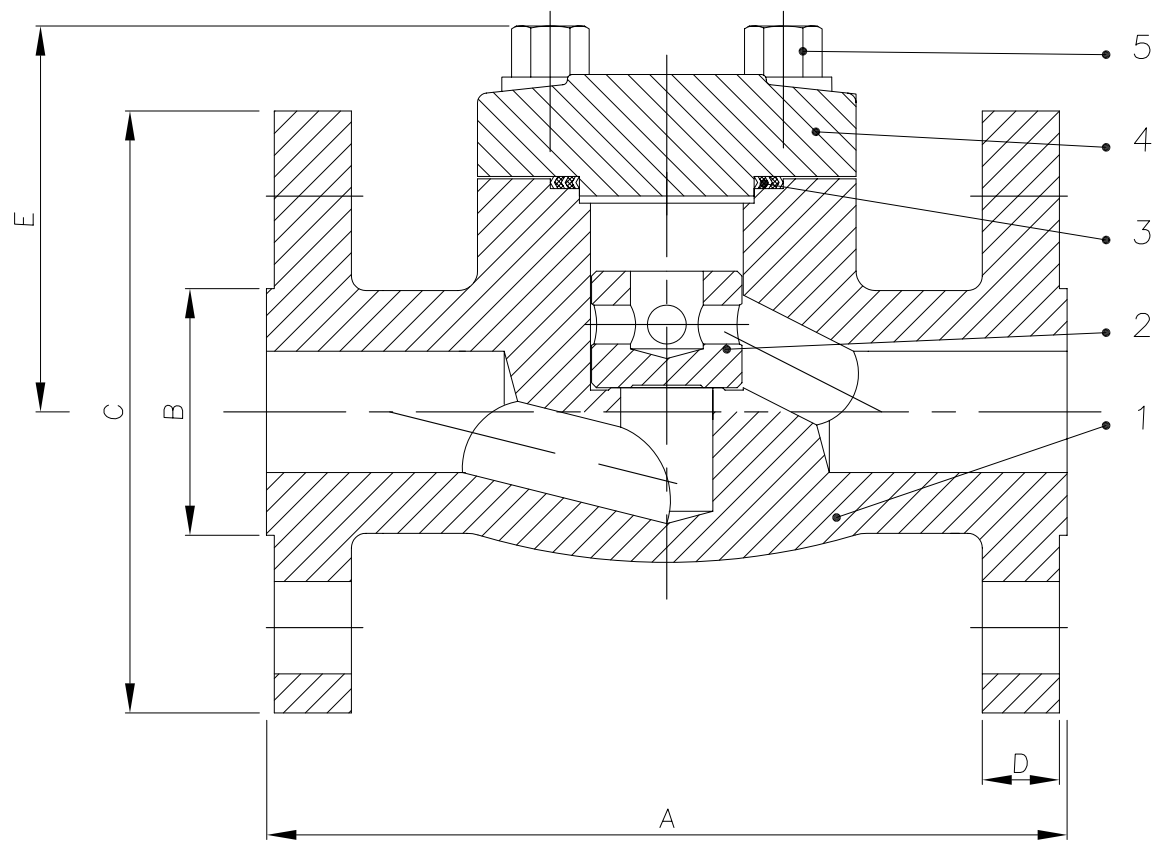

NB	DN	A	B	C	D	E	F	G	Wgt
1/2"	15	152	35	95	14.5	63	10	-	3.6
3/4"	20	178	43	117	16	64	13	-	4.2
1"	25	203	51	124	17.5	79	18	-	6.1
1 1/4"	32	216	63.5	133	19.5	84	23	-	9.8
1 1/2"	40	229	73	156	21	105	27	-	13
2"	50	267	92	163	22.5	124	33	-	16

Materials available on request: Stainless steel all grades; Duplex & Super Duplex; Chrome-moly; Inconel; Monel;

REV	DATE	DESCRIPTION	BY	CHK	APP	SCALE:		
-	-	-				DRAWN	DM	DATE: 14/12/10
						CHECKED	SMN	DATE
						APPROVED	AW	DATE

DESIGN CODE	API 602/ANSI B16.34	TEST PRESSURES		
FACE TO FACE DIMENSIONS	ANSI B 16.10	BODY	76.0	Barg
ENDS FLANGES DIMENSIONS	ASME B16.5	SEAT	56.0	Barg
TESTING CODE	API 598	BACKSEAT	56.0	Barg
		AIR - SEAT	6.0	Barg

DRAWING TITLE:
API FORGED, CLASS 300
BOLTED COVER, RF, PISTON CHECK VALVES

CLIENT: .

VENDOR PO REF: .

EVC REF: .

CAD. No. DRAWING NUMBER: 120182 REV 00

AREA No. FACILITY TYPE SEQ. No. SHT. No.

All drawings are subject to copyright, reproduction only with express permission of Edmund Valve Company (1965) Ltd. Subject to updating and revision. All Edmund valves drawings are product specific, it is the clients responsibility to ensure suitability for service. Materials, design and dimensions subject to contract.

MATERIALS TO MAKE MR0175, LATEST EDITION (WETTED PARTS)