

BILL OF MATERIALS			
NO.	Part Name	Materials	Materials
6	Bolt	A193 B8(M)	A193 B7(M)
5	Bonnet	A182 F316(L)	A105
4	Gasket	304SS+Graphite	304SS+Graphite
3	Spring	A276 304	A276 304
2	Disc	A182 F316(L)+STL	A276 420+STL
1	Body+Seat*	A182 F316(L)+STL	A105+STL

\*: Seat integral

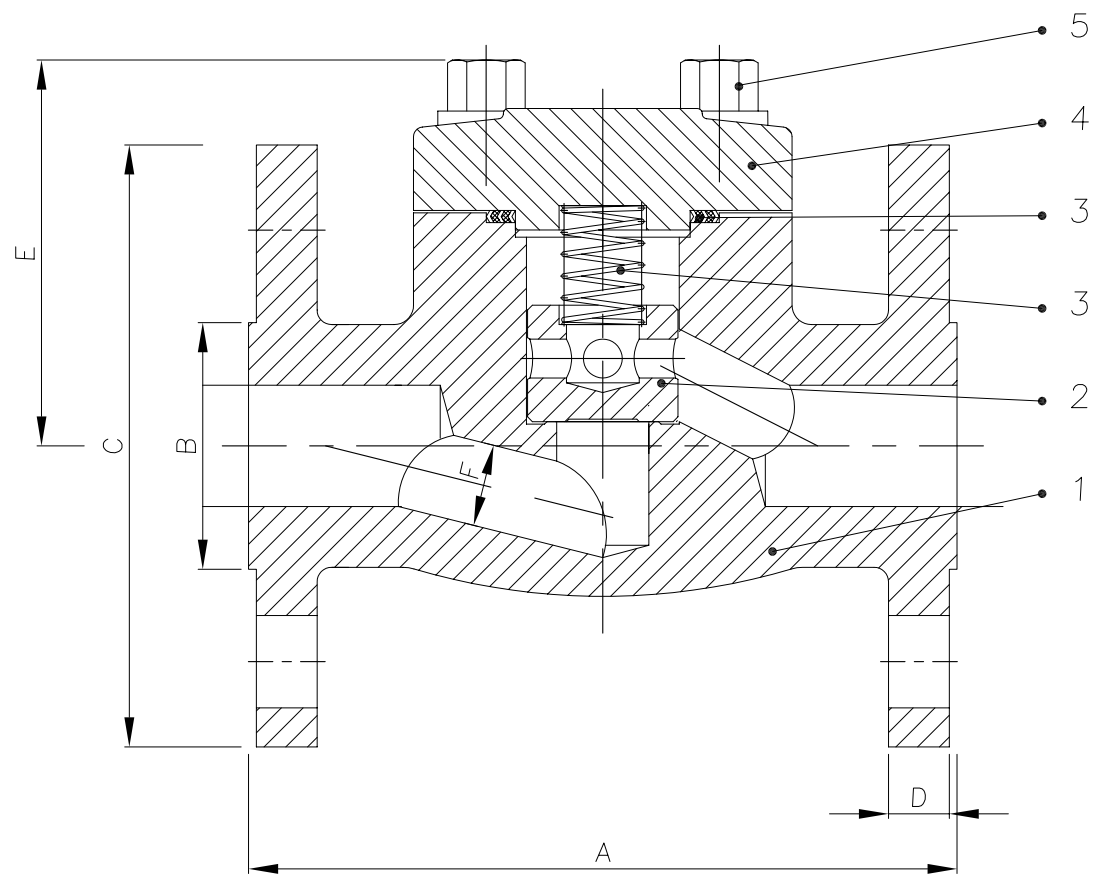

L · C · A · T · H · Q · W

NB	DN	A	B	C	D	E	F	G	Wgt	
60.3	1/2"	15	108	35	89	11.5	78	10	-	2.9
69.8	3/4"	20	117	43	99	13	81	13	-	3.2
79.4	1"	25	127	51	108	14.5	84	18	-	4.3
88.9	1 1/4"	32	140	63.5	117	16	98	23	-	5.8
98.4	1 1/2"	40	165	73	127	17.5	105	27	-	6.5
120.6	2"	50	203	92	152	19.5	124	33	-	14.5

Materials available on request: Stainless steel all grades; Duplex & Super Duplex; Chrome-moly; Inconel; Monel;

REV	DATE	DESCRIPTION	BY	CHK	APP	SCALE:		
-	-	-				DRAWN	DM	DATE: 14/12/10
						CHECKED	SMN	DATE
						APPROVED	AW	DATE

DESIGN CODE	API 602/ANSI B16.34	TEST PRESSURES		
FACE TO FACE DIMENSIONS	ANSI B 16.10	BODY	30.0	Barg
ENDS FLANGES DIMENSIONS	ASME B16.5	SEAT	22.0	Barg
TESTING CODE	API 598	BACKSEAT	22.0	Barg
		AIR - SEAT	6.0	Barg

DRAWING TITLE:  
API FORGED, CLASS 150  
BOLTED COVER, RF, PISTON CHECK VALVES

CLIENT: .

VENDOR PO REF: .

EVC REF: .

CAD. No. DRAWING NUMBER: 120183 REV 00

AREA No. | FACILITY | TYPE | SEQ. No. | SHT. No.

All drawings are subject to copyright, reproduction only with express permission of Edmund Valve Company (1965) Ltd. Subject to updating and revision. All Edmund valves drawings are product specific, it is the clients responsibility to ensure suitability for service. Materials, design and dimensions subject to contract. MATERIALS TO MAKE MR0175 LATEST EDITION (WETTED PARTS)