

Detail B

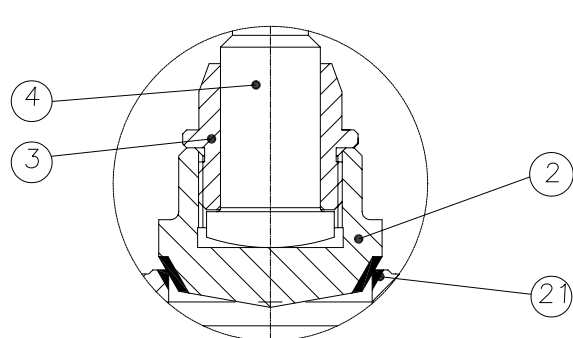

Detail A

BILL OF MATERIALS				
NO.	DESIGNATION	QTY	MATERIAL	NOTES
1	BODY	1	ASTM A216 WCB	
2	DISC	1	A216 WCB+13Cr.	
3	DISC NUT	1	ASTM A276 F6	
4	STEM	1	A182 F6a	
5	GASKET	1	304+GRAPHITE	
6	BACKSEAT BUSHING	1	A182 F6	
7	BONNET	1	ASTM A216 WCB	
8	BONNET BOLTS		ASTM A193 B7	
9	BONNET NUTS		ASTM A194 2H	
10	STEM PACKING	7	BRAIDED GRAPHITE	
11	PIN	2	CARBON STEEL	
12	GLAND EYE BOLTS	2	ASTM A193 B7	
13	GLAND	1	A182 F6	
14	GLAND FLANGE	1	ASTM A216 WCB	
15	WASHER	2	CARBON STEEL	
16	EYE BOLT NUTS	2	ASTM A194 2H	
17	STEM NUT	1	DUCTILE IRON	
18	HANDWHEEL	1	DUCTILE IRON	
19	HANDWHEEL WASHER	1	CARBON STEEL	
20	HANDWHEEL NUT	1	ASTM A194 2H	
21	SEAT	1	A216 WCB+STL	

ITEM NO.	N.B	DN	L	D	H(Open)
	2"	51	178	152	428
	3"	76	241	191	468
	4"	102	292	229	530
	6"	152	406	279	654
	8"	203	495	343	780
	10"	254	622	406	997
	12"	305	699	483	1080
	14"	337	787	533	1377
	16"	387	914	597	1522
	18"	444	978	635	1514

ENGINEERING DATA

DESIGN CODE	BS1873/ANSI B16.34	TEST PRESSURES		
FACE TO FACE DIMENSIONS	ASME B16.10	BODY	30.0	Barg
ENDS FLANGES DIMENSIONS	ASME B16.5	SEAT	22.0	Barg
TESTING CODE	API 598	BACKSEAT	22.0	Barg
		AIR - SEAT	6.0	Barg

REV	DATE	DESCRIPTION	BY	CHK	APP

SCALE:	
DRAWN	DATE
CHECKED	DATE
APPROVED	DATE

DRAWING TITLE:  
 CAST STEEL CLASS 150  
 BOLTED BONNET, RF, GLOBE VALVES

PROJECT:  
 PACKAGE:  
 VENDOR DOC.NO.:



CAD. No.	DRAWING NUMBER:	120058	REV
	AREA No.	FACILITY	TYPE
	SEQ. No.	SHT. No.	

All drawings are subject to copyright, reproduction only with express permission of Edmund Valve Company (1965) Ltd. Subject to updating and revision. MATERIALS TO NACE MR0175 LATEST EDITION (WETTED PARTS).

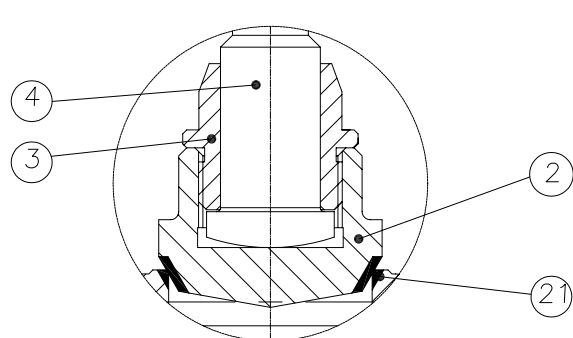
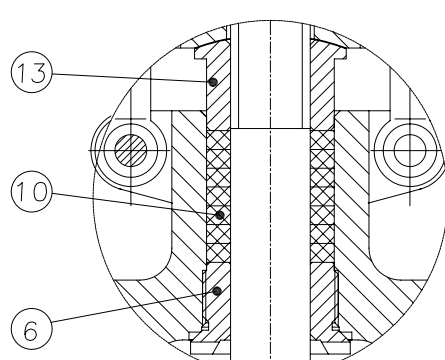
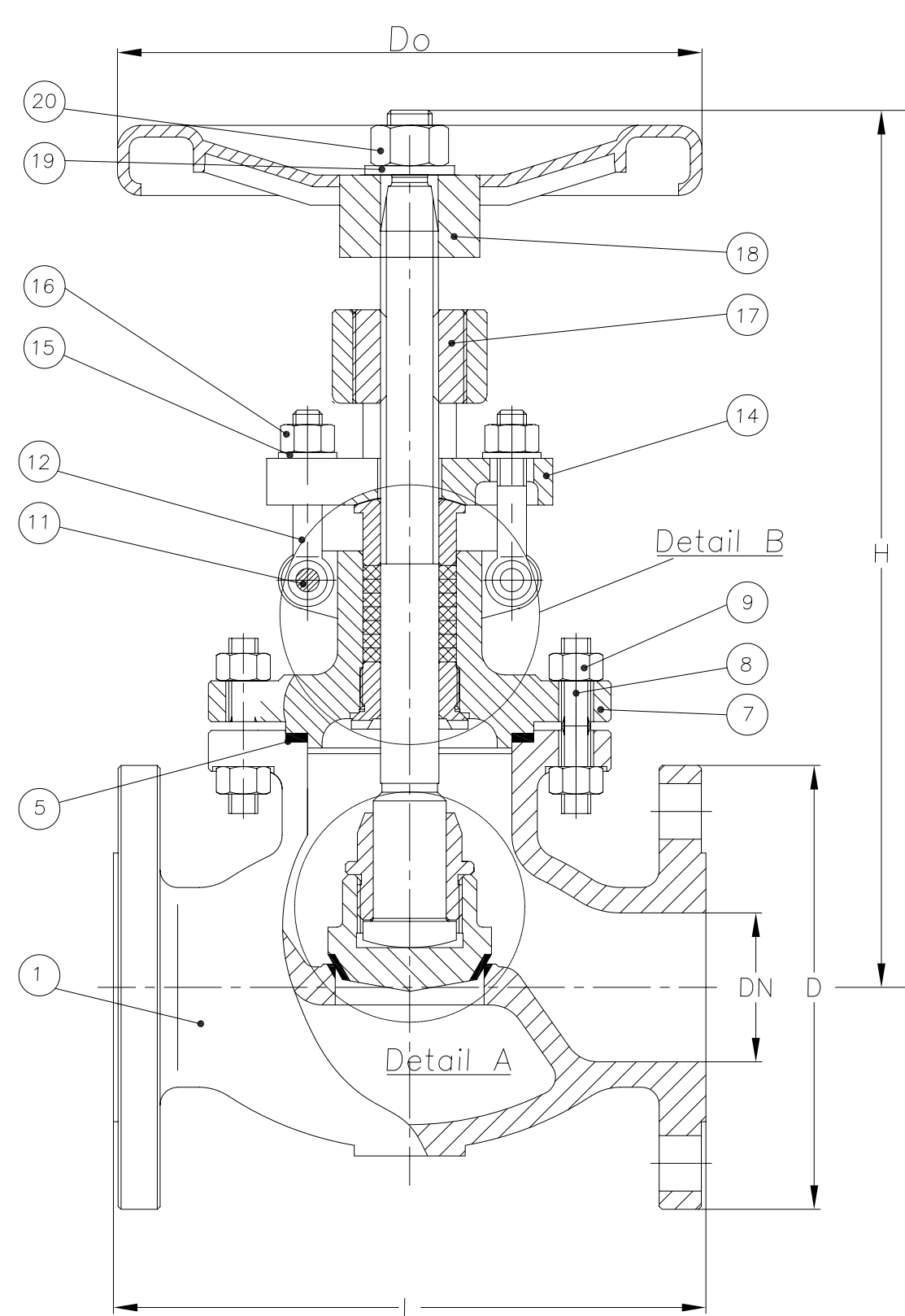

BILL OF MATERIALS				
NO.	DESIGNATION	QTY	MATERIAL	NOTES
1	BODY	1	ASTM A216 WCB	
2	DISC	1	A216 WCB+13Cr.	
3	DISC NUT	1	ASTM A276 F6	
4	STEM	1	A182 F6a	
5	GASKET	1	304+GRAPHITE	
6	BACKSEAT BUSHING	1	A182 F6	
7	BONNET	1	ASTM A216 WCB	
8	BONNET BOLTS		ASTM A193 B7	
9	BONNET NUTS		ASTM A194 2H	
10	STEM PACKING	7	BRAIDED GRAPHITE	
11	PIN	2	CARBON STEEL	
12	GLANG EYE BOLTS	2	ASTM A193 B7	
13	GLAND	1	A182 F6	
14	GLAND FLANGE	1	ASTM A216 WCB	
15	WASHER	2	CARBON STEEL	
16	EYE BOLT NUTS	2	ASTM A194 2H	
17	STEM NUT	1	DUCTILE IRON	
18	HANDWHEEL	1	DUCTILE IRON	
19	HANDWHEEL WASHER	1	CARBON STEEL	
20	HANDWHEEL NUT	1	ASTM A194 2H	
21	SEAT	1	A216 WCB+STL	

ITEM NO.	N.B	DN	L	D	H(Open)
	2"	51	267	165	428
	3"	76	318	210	468
	4"	102	356	254	530
	6"	152	445	318	670
	8"	203	559	381	813
	10"	254	622	445	1075
	12"	305	711	521	1173
	14"	337	838	584	1377
	16"	387	863	648	1522
	18"	444	978	711	1514

ENGINEERING DATA

DESIGN CODE	BS1873/ANSI B16.34	TEST PRESSURES		
FACE TO FACE DIMENSIONS	ASME B16.10	BODY	76.65	Barg
ENDS FLANGES DIMENSIONS	ASME B16.5	SEAT	56.21	Barg
TESTING CODE	API 598	BACKSEAT	56.21	Barg
		AIR - SEAT	6.0	Barg

REV	DATE	DESCRIPTION	BY	CHK	APP

SCALE:	
DRAWN	DATE
CHECKED	DATE
APPROVED	DATE

DRAWING TITLE:  
 CAST STEEL CLASS 300  
 BOLTED BONNET, RF, GLOBE VALVES

PROJECT:  
 PACKAGE:  
 VENDOR DOC.NO.:



CAD. No.	DRAWING NUMBER:	120062	REV
	AREA No.	FACILITY	TYPE
	SEQ. No.	SHT. No.	

All drawings are subject to copyright, reproduction only with express permission of Edmund Valve Company (1965) Ltd. Subject to updating and revision. MATERIALS TO NACE MR0175 LATEST EDITION (WETTED PARTS).

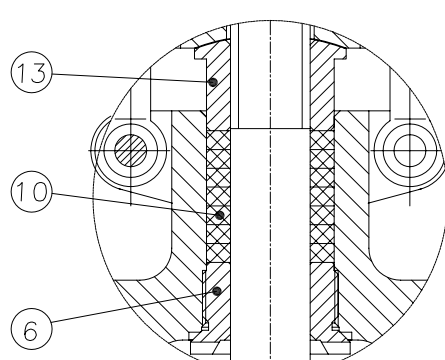
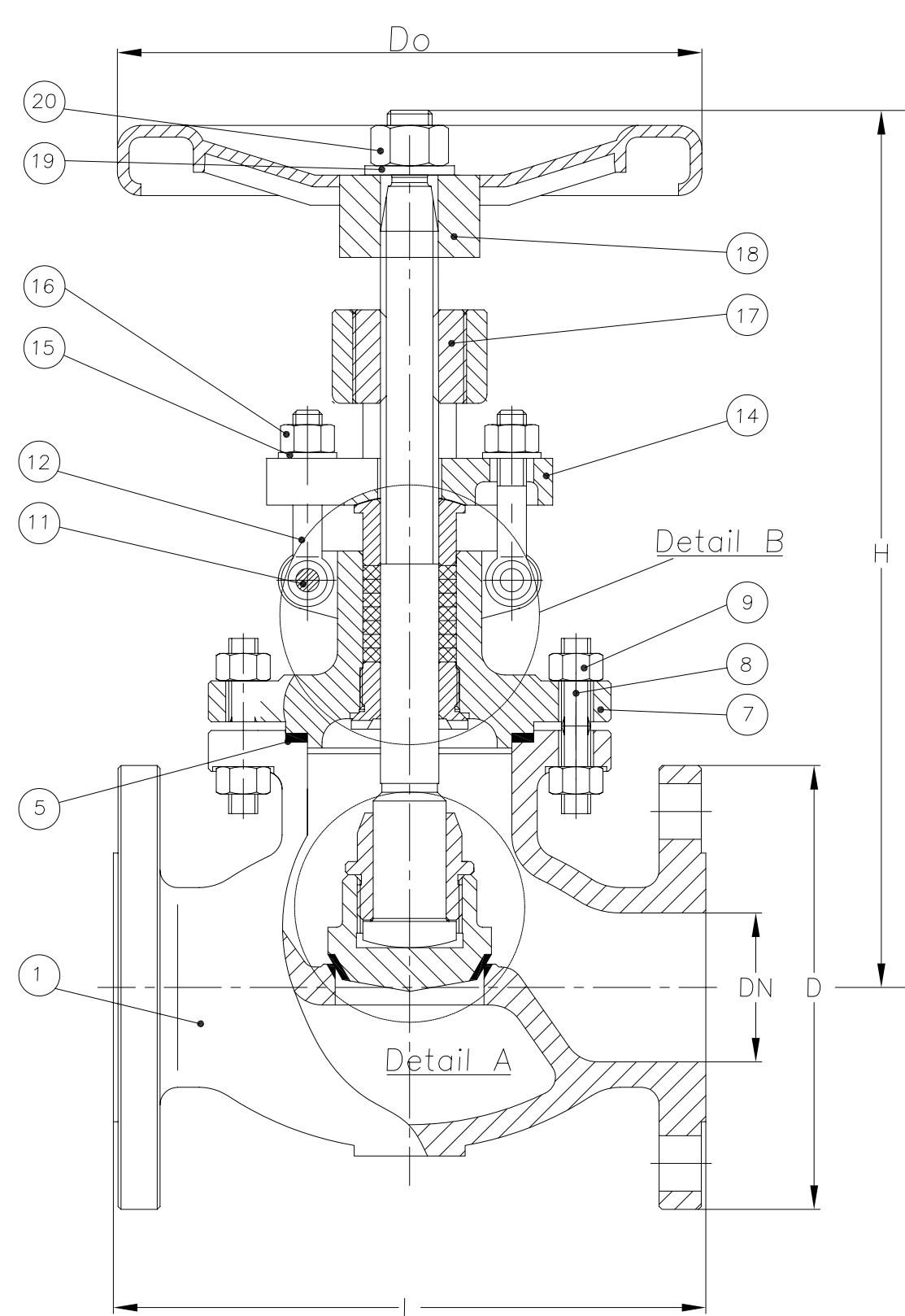

Detail B

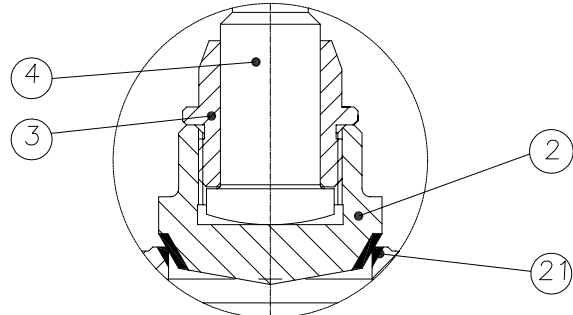

Detail A

BILL OF MATERIALS				
NO.	DESIGNATION	QTY	MATERIAL	NOTES
1	BODY	1	ASTM A216 WCB	
2	DISC	1	A216 WCB+13Cr.	
3	DISC NUT	1	ASTM A276 F6	
4	STEM	1	A182 F6a	
5	GASKET	1	304+GRAPHITE	
6	BACKSEAT BUSHING	1	A182 F6	
7	BONNET	1	ASTM A216 WCB	
8	BONNET BOLTS		ASTM A193 B7	
9	BONNET NUTS		ASTM A194 2H	
10	STEM PACKING	7	BRAIDED GRAPHITE	
11	PIN	2	CARBON STEEL	
12	GLAND EYE BOLTS	2	ASTM A193 B7	
13	GLAND	1	A182 F6	
14	GLAND FLANGE	1	ASTM A216 WCB	
15	WASHER	2	CARBON STEEL	
16	EYE BOLT NUTS	2	ASTM A194 2H	
17	STEM NUT	1	DUCTILE IRON	
18	HANDWHEEL	1	DUCTILE IRON	
19	HANDWHEEL WASHER	1	CARBON STEEL	
20	HANDWHEEL NUT	1	ASTM A194 2H	
21	SEAT	1	A216 WCB+STL	

ITEM NO.	N.B	DN	L	D	H(Open)
	2"	51	292	165	434
	3"	76	356	210	513
	4"	102	432	273	607
	6"	152	559	356	793
	8"	200	660	419	1060
	10"	248	787	508	1198

ENGINEERING DATA

DESIGN CODE	BS1873/ANSI B16.34	TEST PRESSURES		
FACE TO FACE DIMENSIONS	ASME B16.10	BODY	153.15	Barg
ENDS FLANGES DIMENSIONS	ASME B16.5	SEAT	112.31	Barg
TESTING CODE	API 598	BACKSEAT	112.31	Barg
		AIR - SEAT	6.0	Barg

REV	DATE	DESCRIPTION	BY	CHK	APP

SCALE:	
DRAWN	DATE
CHECKED	DATE
APPROVED	DATE

DRAWING TITLE:  
CAST STEEL CLASS 600  
BOLTED BONNET, RF, GLOBE VALVES

PROJECT:  
PACKAGE:  
VENDOR DOC.NO.:



CAD. No.	DRAWING NUMBER: 1200656	REV
AREA No.	FACILITY	TYPE
SEQ. No.	SHT. No.	

All drawings are subject to copyright, reproduction only with express permission of Edmund Valve Company (1965) Ltd. Subject to updating and revision. MATERIALS TO NACE MR0175 LATEST EDITION (WETTED PARTS).

1 | 2 | 3 | 4 | 5 | 6 | 7 | 8

A

B

C

D

E

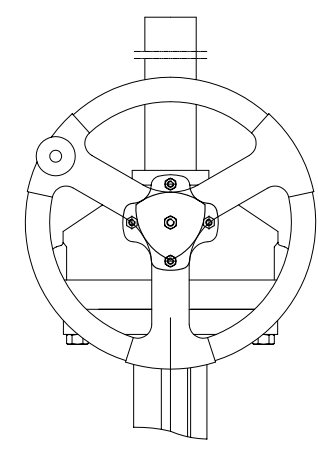
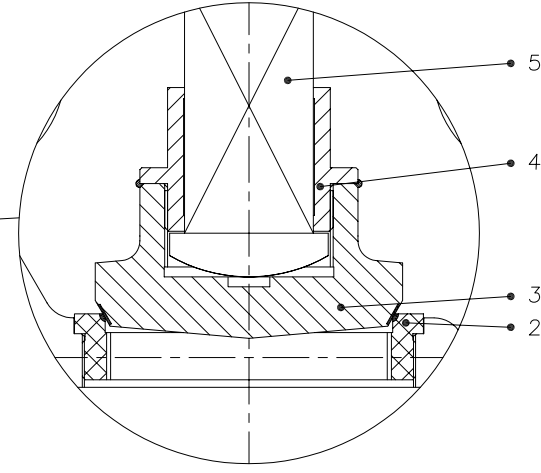
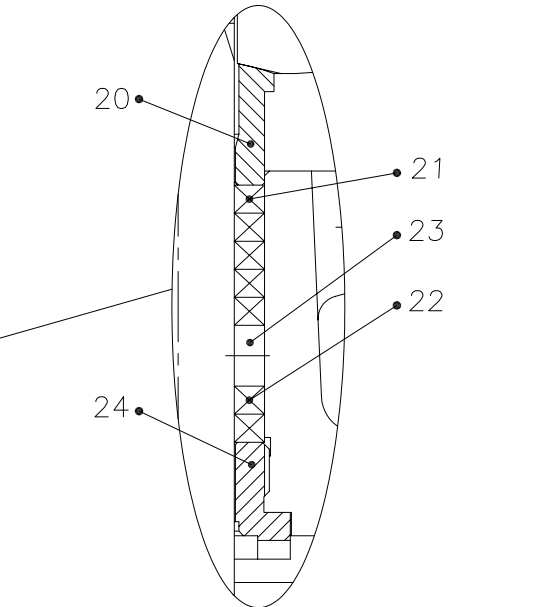
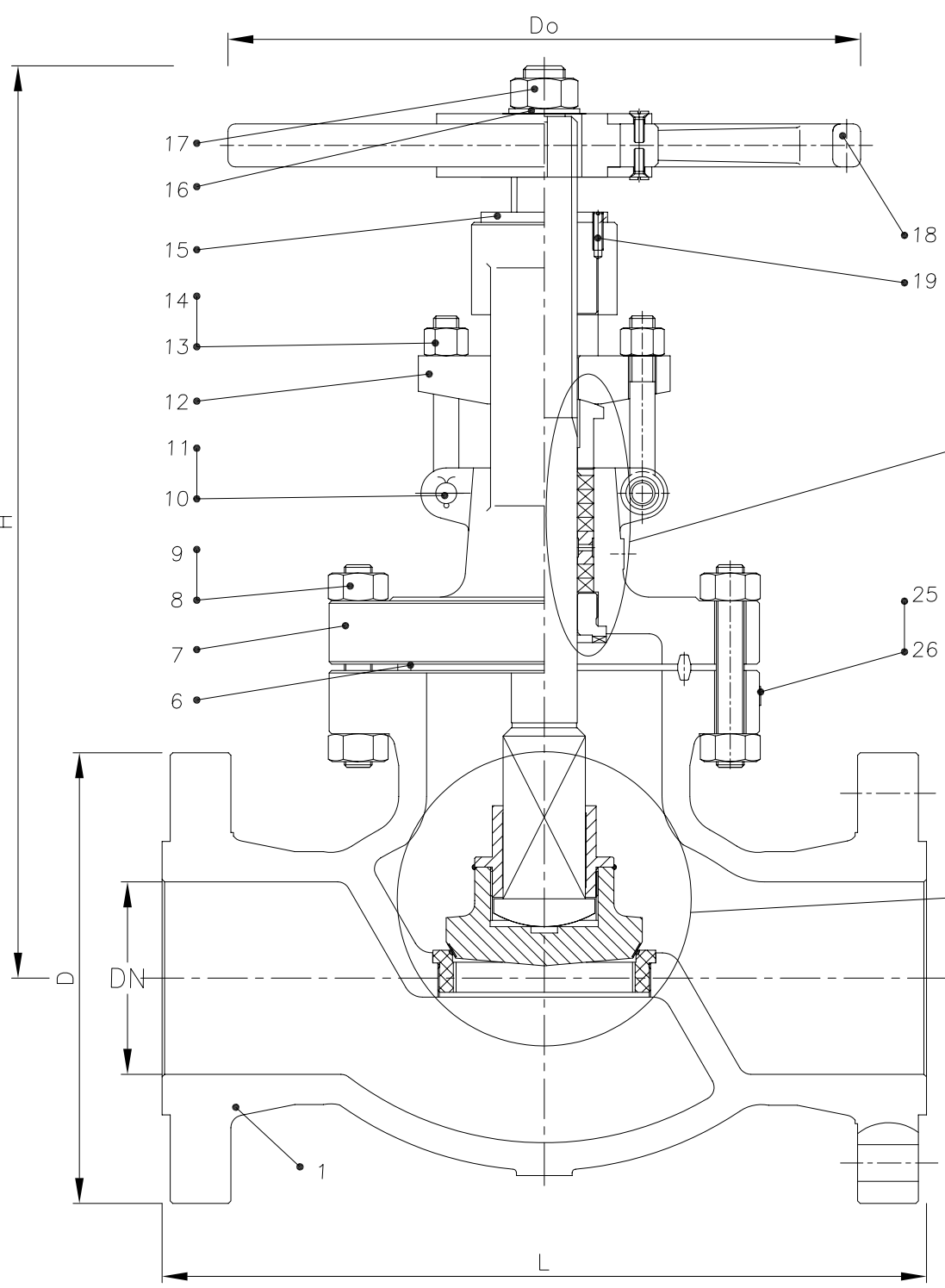

GEAR OP

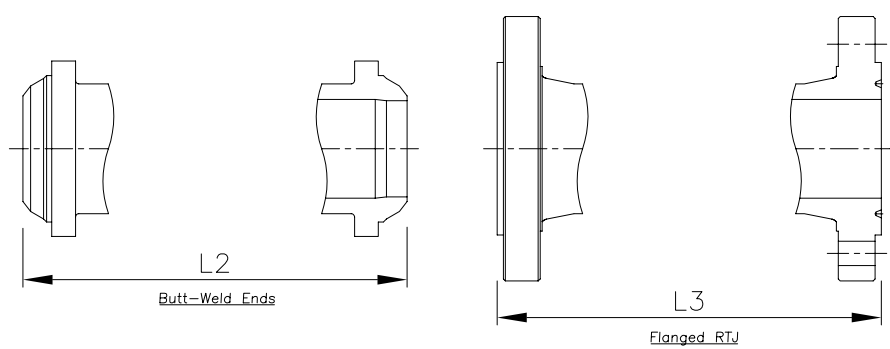

BILL OF MATERIALS

NO	Part Name	Qty.	Material
1	Body	1	A216 WCB
2	Seat Ring	2	A105+STL
3	Disc	1	A105+STL
4	Disc Cover	1	A276 410
5	Stem	1	A182 F6a
6	Gasket	1	A276 410
7	Bonnet	1	A216 WCB
8	Bolt		A193 B7
9	Nut		A194 2H
10	Pin	2	ANSI 1035
11	Split Pin	2	Carbon Steel
12	Gland Flange	1	A216 WCB
13	Eye Bolt	2	A193 B7
14	Eye Nut	2	A194 2H
15	Stem Nut	1	A439 D-2
16	Washer	1	Carbon Steel
17	Nut	1	Carbon Steel
18	Handwheel	1	A536 60-40-18
19	Screw	1	Carbon Steel
20	Gland Busher	1	A276 316
21	Packing	2	Stainless Steel Wire
22	Packing	4~5	Flexible Graphite
23	Spacer	1	A276 410
24	Back Seat	1	A276 410
25	Rivet	2	304SS
26	Name Plate	1	304SS

Materials available on request: Stainless steel all grades; Duplex & Super Duplex; Chrome-moly; Inconel; Monel;

N.B	DN	L	L2	L3	D	Do	H(Open)	Wgt*
2"	43	368	368	371	216	400	695	111
3"	66	381	470	473	241	400	775	95
4"	92	457	546	549	292	400	855	180
6"	139	610	705	711	381	560	1288	450
8"	182	737	832	841	470	800	1665	1125
10"	230	838	991	1000	546	800	1600	1845
12"	273	965	1131	1146	610	900	1705	2385
14"	300	1029	1257	1276	641	900	2210	3285
16"	344	1130	1383	1407	705	900	2620	3870

NOTE: BW Schedule to suit client order  
\* Wgt for RF valves only

ENGINEERING DATA

DESIGN CODE	BS 1873/ANSI B16.34	TEST PRESSURES		
FACE TO FACE DIMENSIONS	ASME B16.10	BODY	229.8	Barg
ENDS FLANGES DIMENSIONS	ASME B16.5/16.25	SEAT	168.52	Barg
TESTING CODE	API 598	BACKSEAT	168.52	Barg
		AIR - SEAT	6.0	Barg

REV	DATE	DESCRIPTION	BY	CHK	APP	SCALE:		
						DRAWN	SMN	DATE 02.12.10
						CHECKED	AW	DATE
						APPROVED	AW	DATE

DRAWING TITLE:  
API CAST STEEL CLASS 900  
BOLTED BONNET, RF/RTJ/BWE, GLOBE VALVES

CLIENT:  
VENDOR PO REF:  
EVC REF:



CAD. No. DRAWING NUMBER: 120172 REV 00  
AREA No. FACILITY TYPE SEQ. No. SHT. No.

1 | 2 | 3 | 4 | 5 | 6 | 7 | 8

All drawings are subject to copyright, reproduction only with express permission of Edmund Valve Company, (1965) Ltd. Subject to updating and revisions all Edmund valve drawings are product specific, it is the clients responsibility to ensure suitability for service. Materials, design and dimensions subject to contract. MATERIALS TO NACE MRO175 LATEST EDITION (WETTED PARTS).

1 | 2 | 3 | 4 | 5 | 6 | 7 | 8

A

B

C

D

E

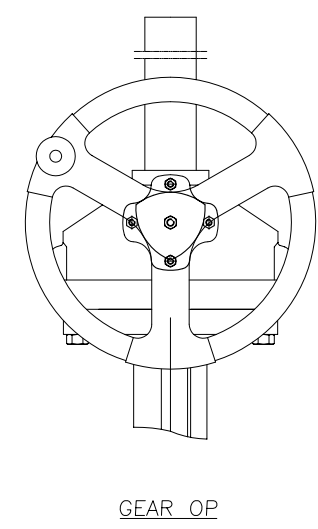
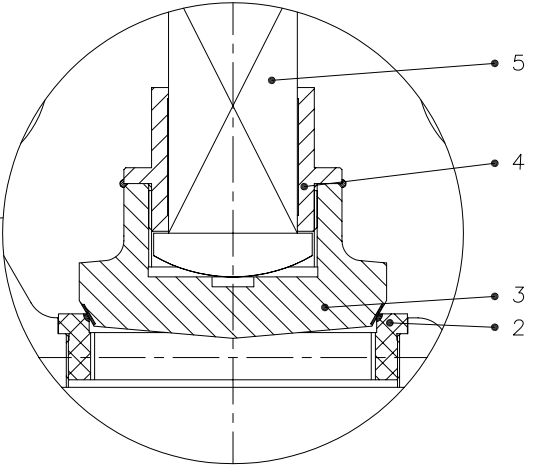
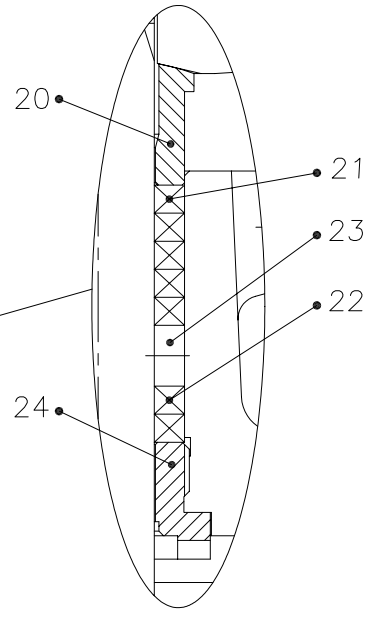
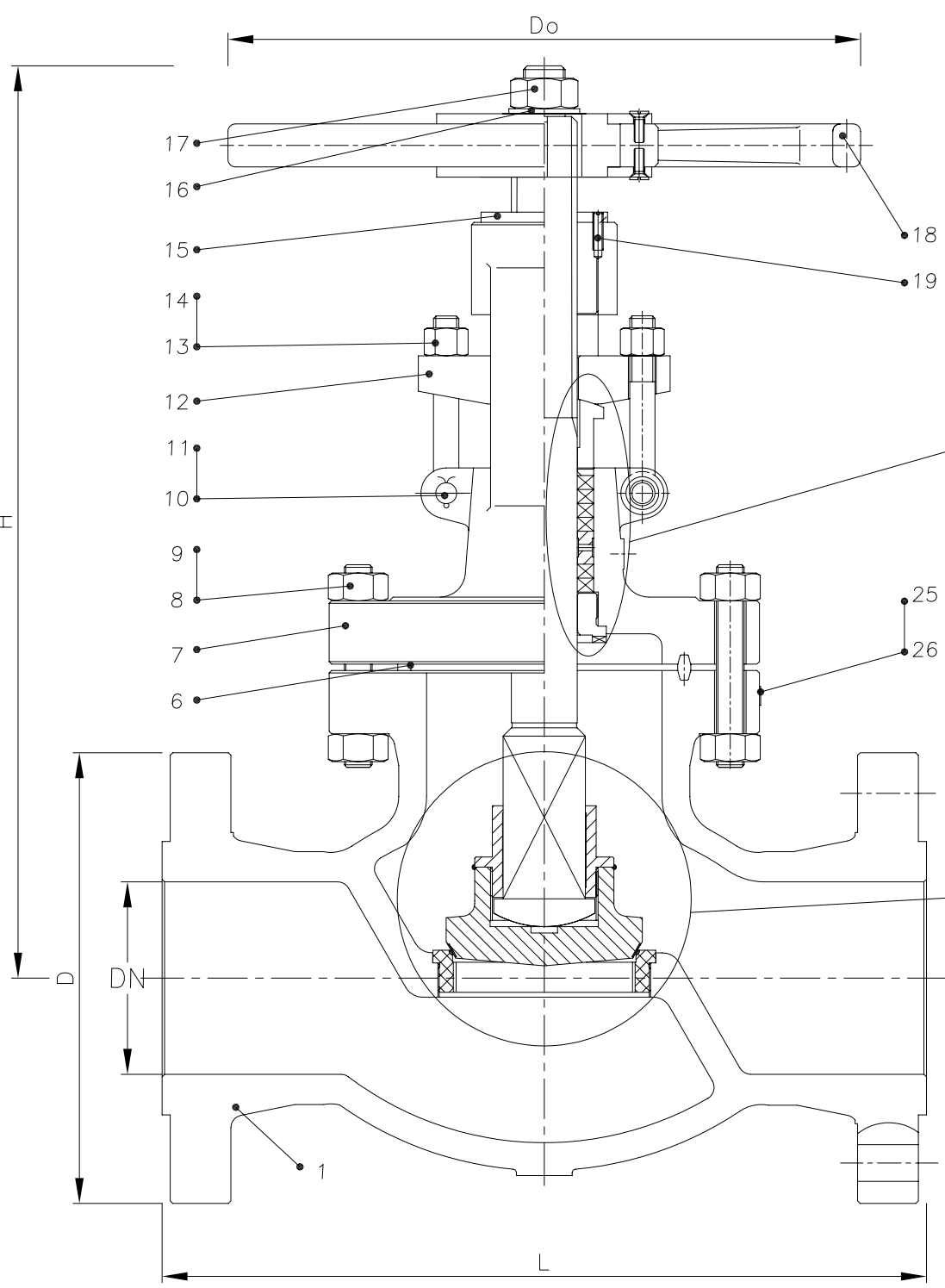

BILL OF MATERIALS

NO	Part Name	Qty.	Material
1	Body	1	A216 WCB
2	Seat Ring	2	A105+STL
3	Disc	1	A105+STL
4	Disc Cover	1	A276 410
5	Stem	1	A182 F6a
6	Gasket	1	A276 410
7	Bonnet	1	A216 WCB
8	Bolt		A193 B7
9	Nut		A194 2H
10	Pin	2	ANSI 1035
11	Split Pin	2	Carbon Steel
12	Gland Flange	1	A216 WCB
13	Eye Bolt	2	A193 B7
14	Eye Nut	2	A194 2H
15	Stem Nut	1	A439 D-2
16	Washer	1	Carbon Steel
17	Nut	1	Carbon Steel
18	Handwheel	1	A536 60-40-18
19	Sorew	1	Carbon Steel
20	Gland Busher	1	A276 316
21	Packing	2	Stainless Steel Wire
22	Packing	4~5	Flexible Graphite
23	Spacer	1	A276 410
24	Back Seat	1	A276 410
25	Rivet	2	304SS
26	Name Plate	1	304SS

Materials available on request: Stainless steel all grades; Duplex & Super Duplex; Chrome-moly; Inconel; Monel;

N.B	DN	L	L2	L3	D	Do	H(Open)	Wgt*
2"	43	368	368	371	216	300	695	111
3"	66	470	470	473	266	400	799	164
4"	92	546	546	549	311	500	1015	306
6"	139	705	705	711	393	560	1345	605
8"	182	832	832	841	482	560	1960	1890
10"	230	991	991	1000	584	710	2310	2880
12"	273	1131	1131	1146	673	710	2670	3960
14"	300	1257	1257	1276	749	760	3200	4860
16"	344	1383	1383	1407	825	760	4064	6030

NOTE: BW Schedule to suit client order  
\* Wgt for RF valves only

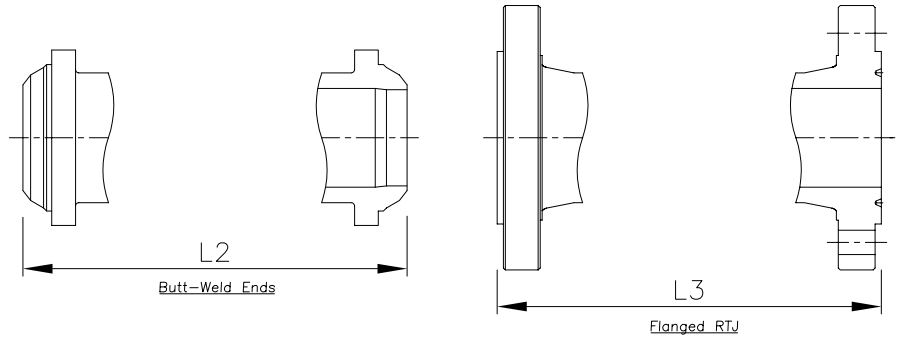

ENGINEERING DATA

DESIGN CODE	BS 1873/ANSI B16.34	TEST PRESSURES		
FACE TO FACE DIMENSIONS	ASME B16.10	BODY	382.95	Barg
ENDS FLANGES DIMENSIONS	ASME B16.5/16.25	SEAT	280.83	Barg
TESTING CODE	API 598	BACKSEAT	280.83	Barg
		AIR - SEAT	6.0	Barg

REV	DATE	DESCRIPTION	BY	CHK	APP	SCALE:		
						DRAWN	SMN	DATE 02.12.10
						CHECKED	AW	DATE
						APPROVED	AW	DATE

DRAWING TITLE:  
API CAST STEEL CLASS 1500  
BOLTED BONNET, RF/RTJ/BWE, GLOBE VALVES

CLIENT:  
VENDOR PO REF:  
EVC REF:



CAD. No. DRAWING NUMBER: 120173 REV 00  
AREA No. FACILITY TYPE SEQ. No. SHT. No.

1 | 2 | 3 | 4 | 5 | 6 | 7 | 8

All drawings are subject to copyright, reproduction only with express permission of Edmund Valve Company, (1965) Ltd. Subject to updating and revisions all Edmund valve drawings are product specific, it is the clients responsibility to ensure suitability for service. Materials, design and dimensions subject to contract. MATERIALS TO NACE MR0175 LATEST EDITION (WETTED PARTS).