

FIRE SAFE DESIGN TO API 607; TEST AND INSPECTION TO API 598; VALVES ARE IN ACCORDANCE WITH NACE MR-01-75 LATEST REV
All drawings are subject to copyright, reproduction only with express permission of Edmund Valve Company (1965) Ltd. Subject to updating and revision.

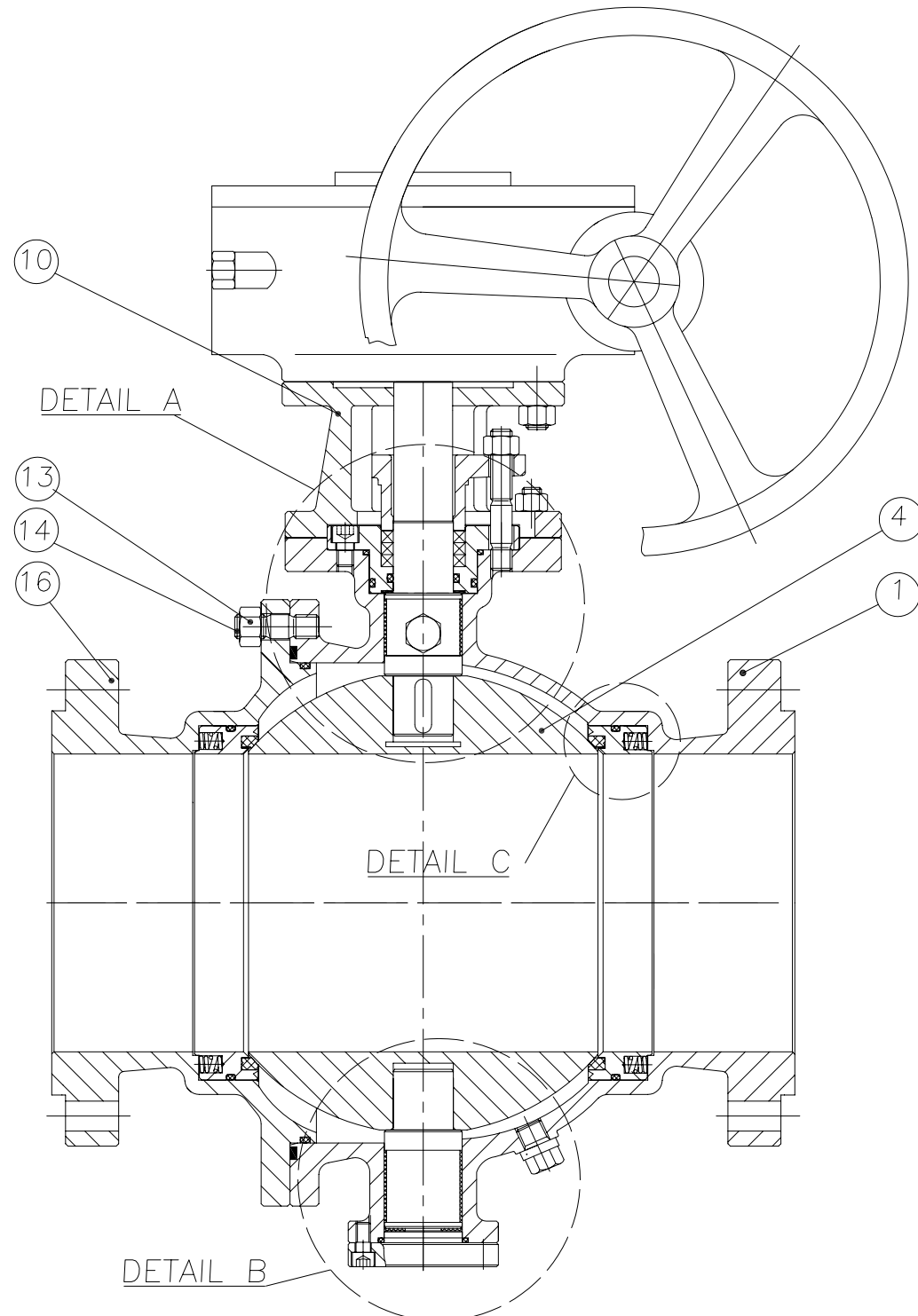

LEVER OPERATED 6" AND BELOW

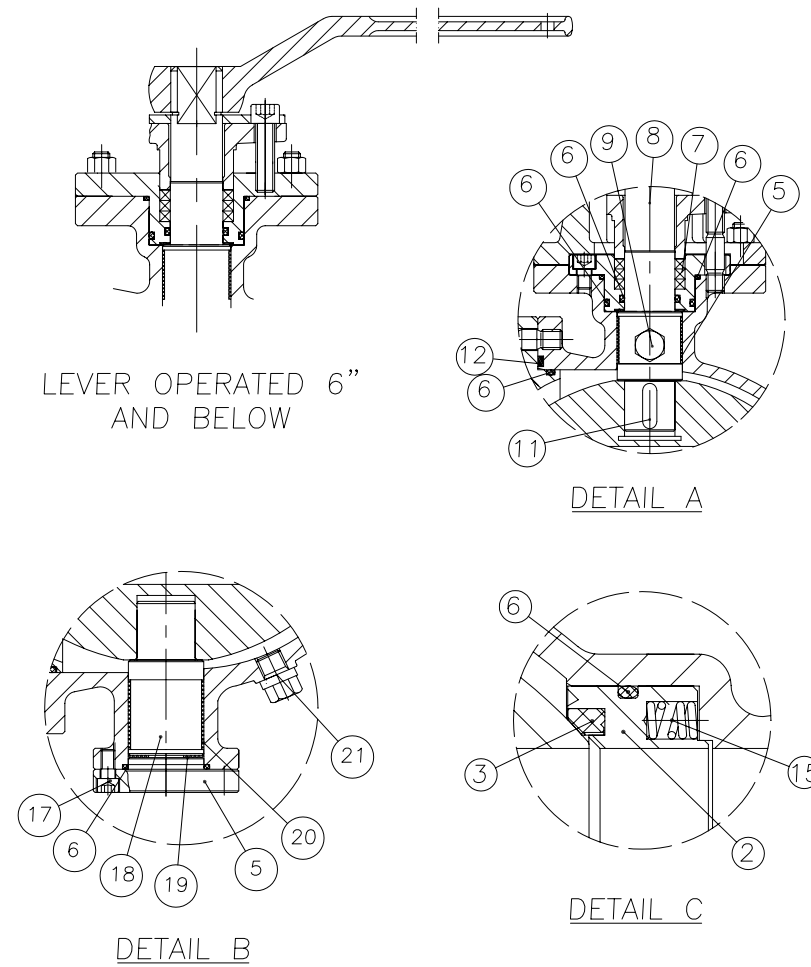

NO	PART NAME	MATERIAL	NOTES
21	DRAIN VALVE	AISI 1020+Zn	
20	BOTTOM COVER	ASTM A216 WCB/A105	
19	LOWER THRUST WASHER	PTFE	
18	FIXED SPINDLE	A182 F316	
17	SCREW	A193 GR.B7M	
16	BONNET/CLOSURE	ASTM A216 WCB	
15	SPRING	AISI 304 SS	
14	STUD	A193 GR.B7M	
13	NUTS	A194 GR.2HM	
12	GASKET	SS316+GRAPHITE	
11	KEY	A182 F316	
10	SUPPORT	ASTM A216 WCB	
9	VENT VALVE	AISI 1020+Zn	
8	STEM	A182 F316	
7	PACKING	PTFE	
6	O-RING	VITON	
5	SLIDING BEARING	PTFE/STAINLESS STEEL	
4	BALL	AISI 316 SS	
3	SEAT	RPTFE	
2	SEAT CARRIER	A182 F316	
1	BODY	ASTM A216 WCB	

NOTES	
1	
2	
3	

Size	A			B	B1	C
	RF	RTJ	WE			
2"	178	190	216	51	51	152
3"	203	216	283	77	77	190
4"	229	241	305	102	102	230
6"	394	406	457	152	152	279.5
8"	457	470	521	203	203	343
10"	533	546	559	254	254	406
12"	610	622	635	305	305	483
14"	686	698	762	337	337	535
16"	762	775	838	387	387	597
18"	864	876	914	438	438	635
20"	914	927	991	489	489	700
24"	1067	1079	1143	591	591	813

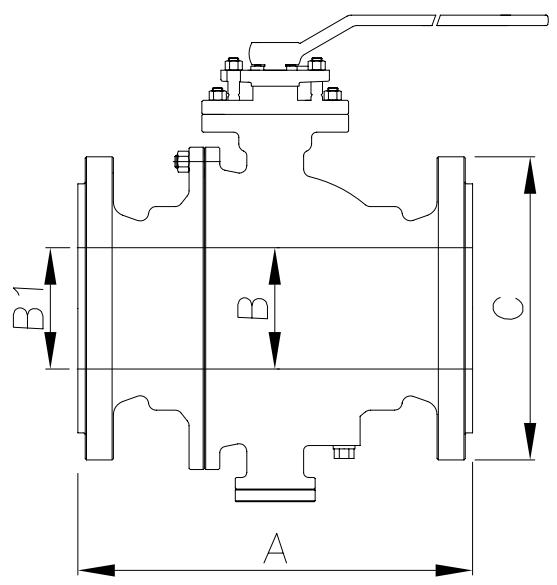

DESIGN CODE	API 6D/ANSI B16.34	TEST PRESSURES		
FACE TO FACE DIMENSIONS	ASME B16.10	BODY	30.0	Barg
ENDS FLANGES DIMENSIONS	ASME B16.5	SEAT	22.0	Barg
TESTING CODE	API 598	SEAT - AIR	6.0	Barg

REV	DATE	DESCRIPTION	BY	CHK	APP	SCALE:		
						DRAWN	DM	DATE
						CHECKED	SMN	DATE
						APPROVED	AW	DATE

DRAWING TITLE:
API 6D, CARBON STEEL CLASS 150
TRUNNION MOUNTED, RF, BALL VALVE

CLIENT: PETROPIPE INTERNATIONAL

VENDOR PO REF: 2850

EVC REF: 303001

CAD. No. | DRAWING NUMBER: 120001 | REV 01
AREA No. | FACILITY | TYPE | SEQ. No. | SHF. No.

FIRE SAFE DESIGN TO API 607; TEST AND INSPECTION TO API 598; VALVES ARE IN ACCORDANCE WITH NACE MR-01-75 LATEST REV
 All drawings are subject to copyright, reproduction only with express permission of Edmund Valve Company (1965) Ltd. Subject to updating and revision.

21	DRAIN VALVE	AISI 1020+Zn	
20	BOTTOM COVER	ASTM A216 WCB/A105	
19	LOWER THRUST WASHER	PTFE	
18	FIXED SPINDLE	A182 F316	
17	SCREW	A193 GR.B7M	
16	BONNET/CLOSURE	ASTM A216 WCB	
15	SPRING	AISI 304 SS	
14	STUD	A193 GR.B7M	
13	NUTS	A194 GR.2HM	
12	GASKET	SS316+GRAPHITE	
11	KEY	A182 F316	
10	SUPPORT	ASTM A216 WCB	
9	VENT VALVE	AISI 1020+Zn	
8	STEM	A182 F316	
7	PACKING	PTFE	
6	O-RING	VITON	
5	SLIDING BEARING	PTFE/STAINLESS STEEL	
4	BALL	AISI 316 SS	
3	SEAT	RPTFE	
2	SEAT CARRIER	A182 F316	
1	BODY	ASTM A216 WCB	
NO	PART NAME	MATERIAL	NOTES

NOTES	
1	
2	
3	

Size	A			B	B1	C
	RF	RTJ	WE			
2"	216	232	216	51	51	165
3"	283	296	283	77	77	210
4"	305	321	305	102	102	254
6"	403	419	457	152	152	318
8"	502	517	521	203	203	381
10"	568	584	559	254	254	444.5
12"	648	664	635	305	305	520
14"	762	778	762	337	337	585
16"	838	854	838	387	387	650
18"	914	930	914	438	438	710
20"	991	1010	991	489	489	775
24"	1143	1165	1143	591	591	915

DRAWING TITLE:
 API 6D, CARBON STEEL CLASS 300
 TRUNNION MOUNTED, RF, BALL VALVE
 CLIENT: PETROPIPE INTERNATIONAL
 VENDOR PO REF: 2850
 EVC REF: 303001



CAD. No.	DRAWING NUMBER: 120017	REV
AREA No. 1	FACILITY	TYPE
SEQ. No.	SHT. No.	01

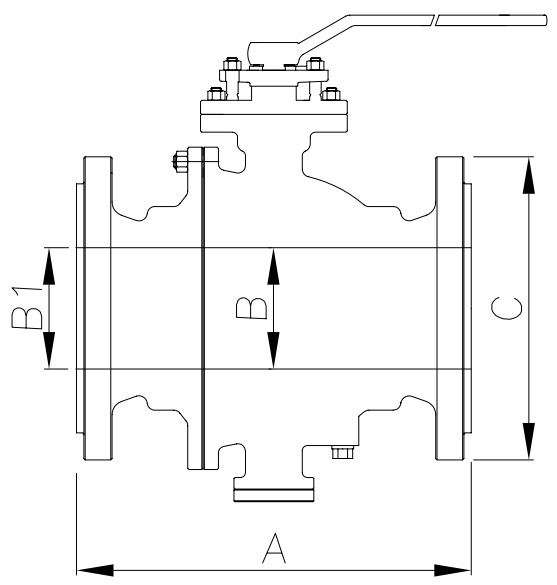
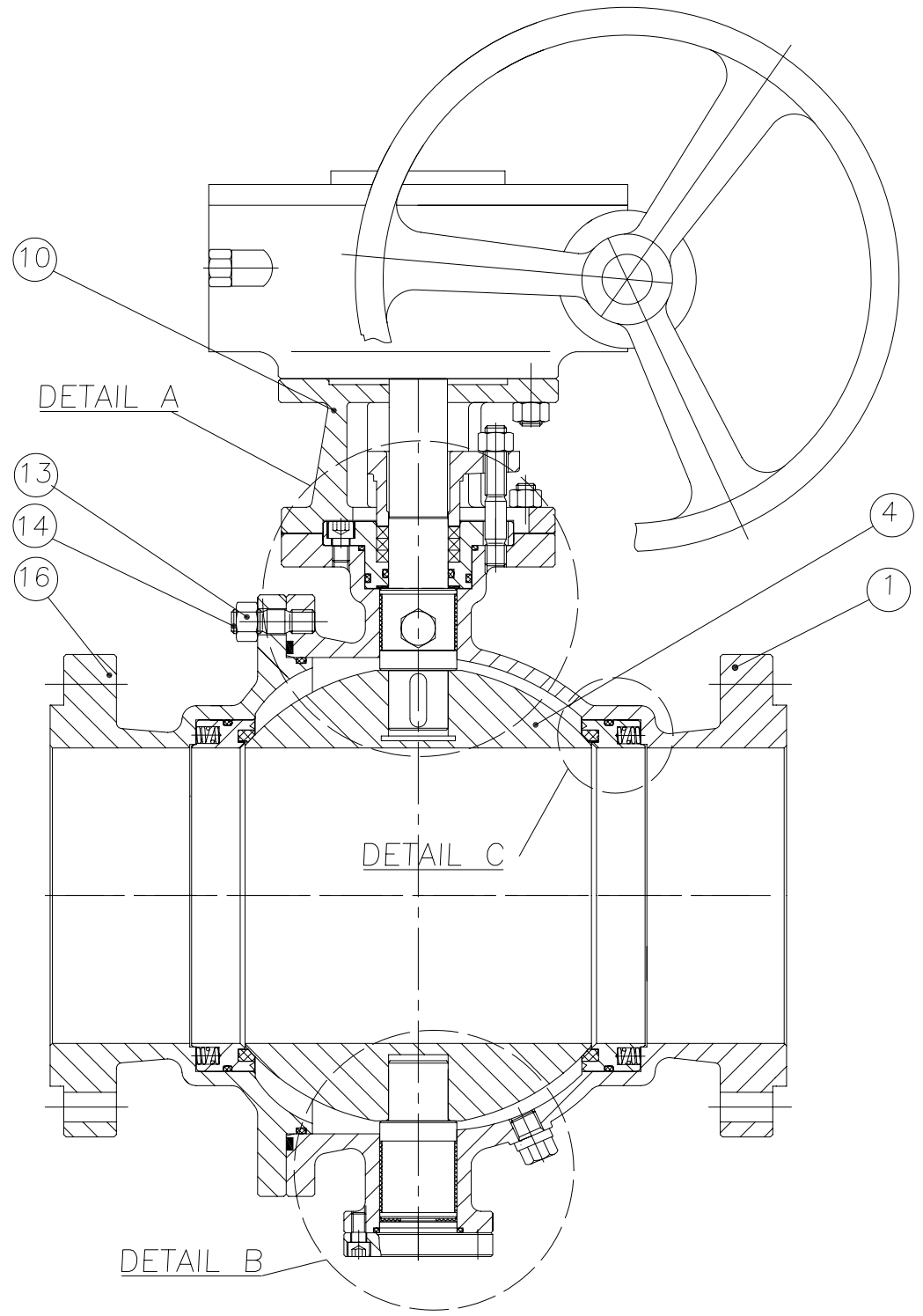
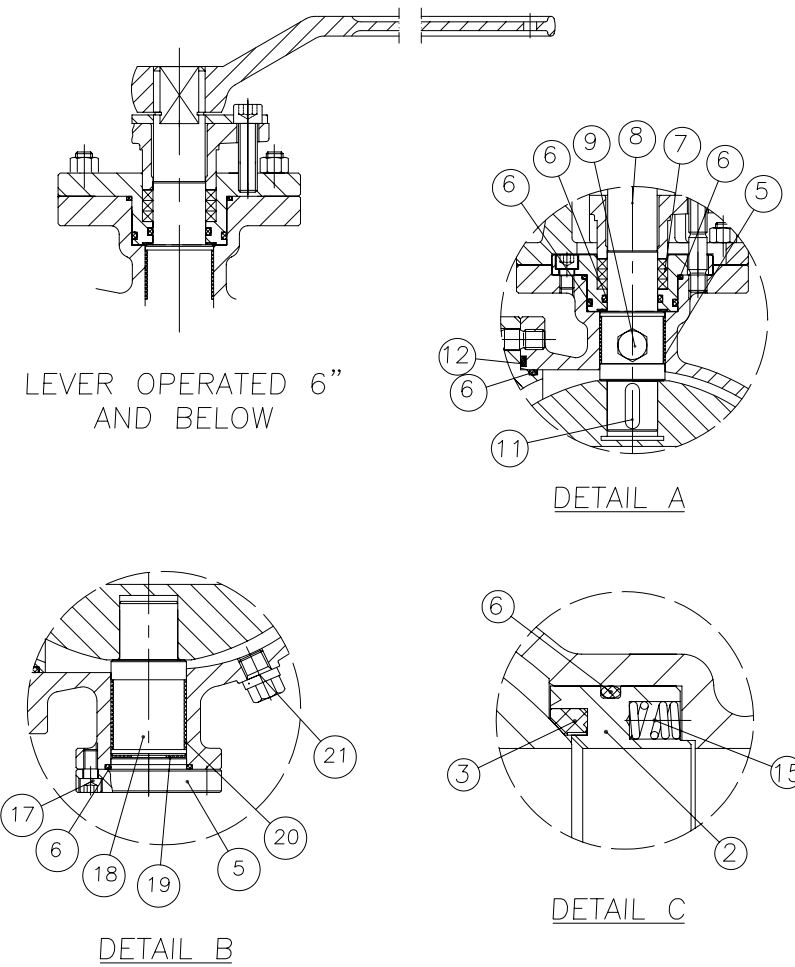

DESIGN CODE	API 6D/ANSI B16.34	TEST PRESSURES		
FACE TO FACE DIMENSIONS	ASME B16.10	BODY	76.6	Barg
ENDS FLANGES DIMENSIONS	ASME B16.5	SEAT	56.2	Barg
TESTING CODE	API 598	SEAT - AIR	6.0	Barg

REV	DATE	DESCRIPTION	BY	CHK	APP	SCALE:		
						DRAWN	DM	DATE
						CHECKED	SMN	DATE
						APPROVED	AW	DATE

FIRE SAFE DESIGN TO API 607; TEST AND INSPECTION TO API 598; VALVES ARE IN ACCORDANCE WITH NACE MR-01-75 LATEST REV
 All drawings are subject to copyright, reproduction only with express permission of Edmund Valve Company (1965) Ltd. Subject to updating and revision.

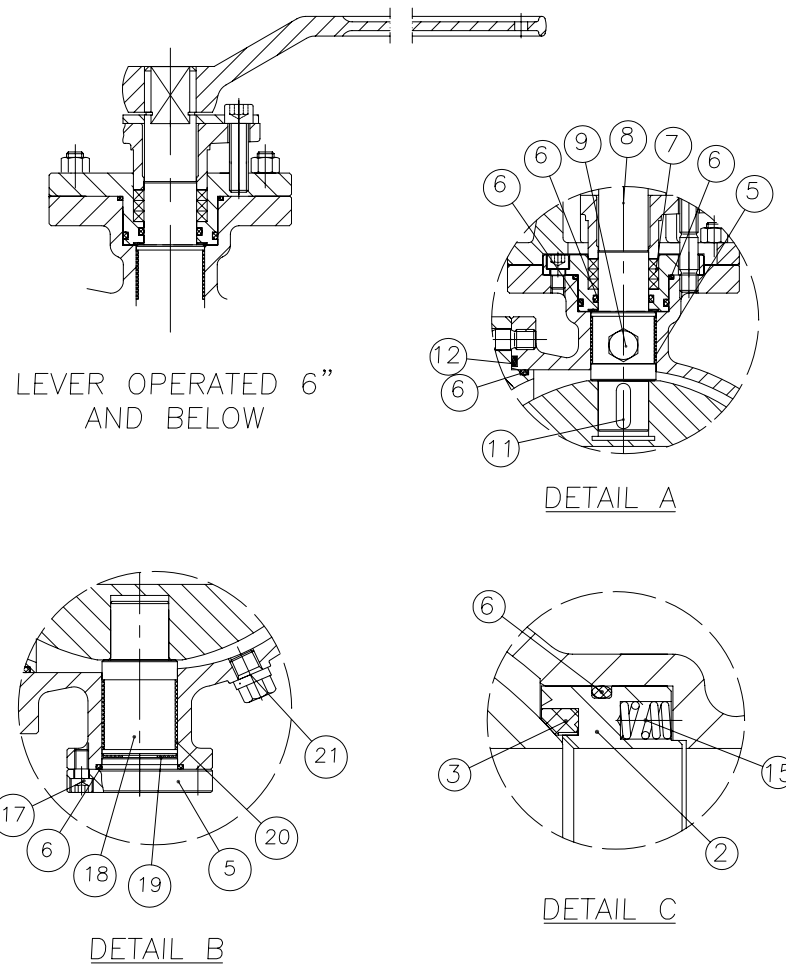
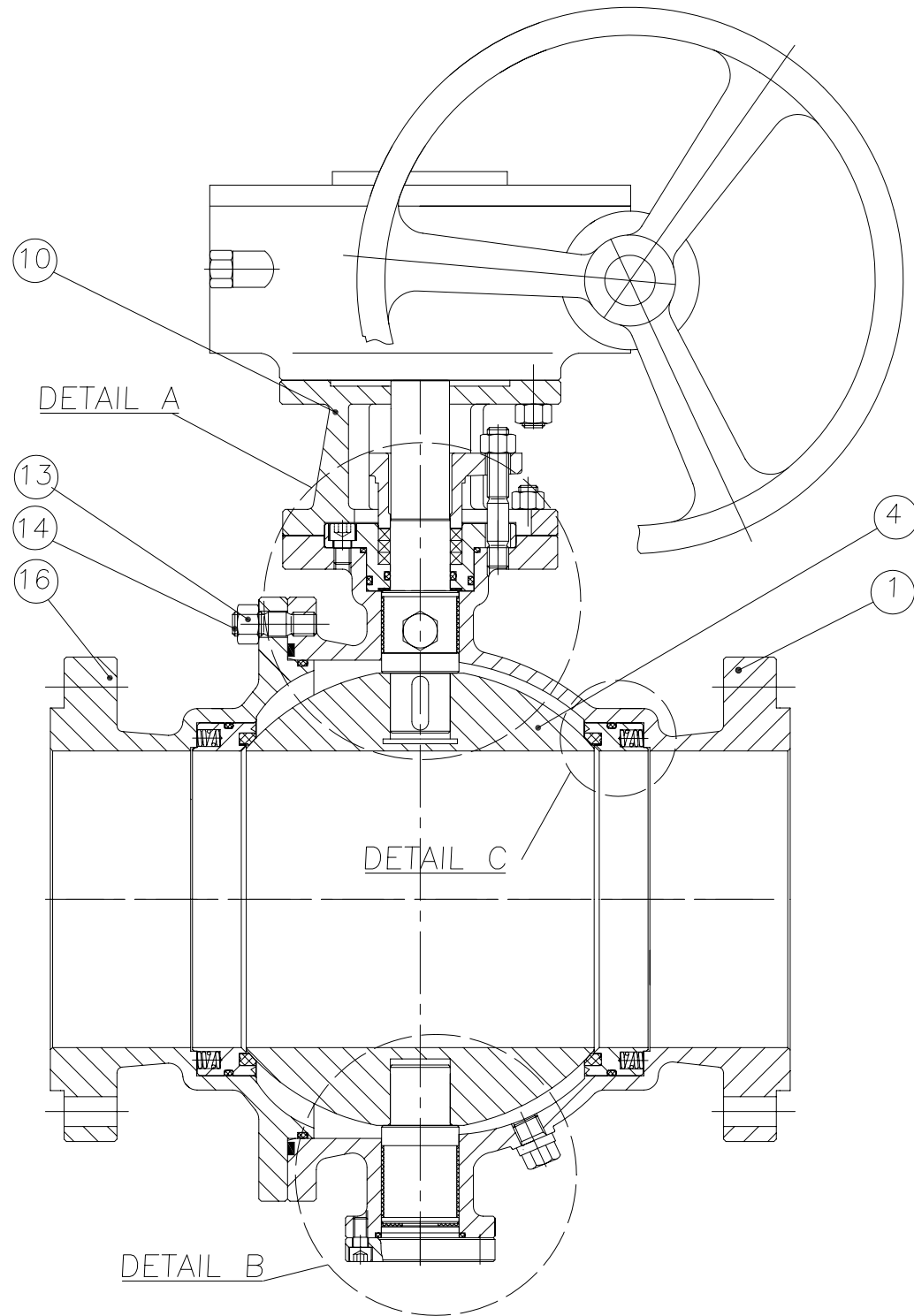

NO	PART NAME	MATERIAL	NOTES
21	DRAIN VALVE	AISI 1020+Zn	
20	BOTTOM COVER	ASTM A216 WCB/A105	
19	LOWER THRUST WASHER	PTFE	
18	FIXED SPINDLE	A182 F316	
17	SCREW	A193 GR.B7M	
16	BONNET/CLOSURE	ASTM A216 WCB	
15	SPRING	AISI 304 SS	
14	STUD	A193 GR.B7M	
13	NUTS	A194 GR.2HM	
12	GASKET	SS316+GRAPHITE	
11	KEY	A182 F316	
10	SUPPORT	ASTM A216 WCB	
9	VENT VALVE	AISI 1020+Zn	
8	STEM	A182 F316	
7	PACKING	PTFE	
6	O-RING	VITON	
5	SLIDING BEARING	PTFE/STAINLESS STEEL	
4	BALL	AISI 316 SS	
3	SEAT	NYLON	
2	SEAT CARRIER	A182 F316	
1	BODY	ASTM A216 WCB	

Size	A			B	B1	C
	RF	RTJ	WE			
2"	292	295	292	51	51	165
3"	356	359	356	77	77	210
4"	432	435	432	102	102	273
6"	559	562	559	152	152	356
8"	660	664	660	203	203	419
10"	787	791	787	254	254	510
12"	838	841	838	305	305	559
14"	889	892	889	337	337	605
16"	991	994	991	387	387	685
18"	1092	1095	1092	438	438	745
20"	1194	1200	1194	489	489	815
24"	1397	1406	1397	591	591	940

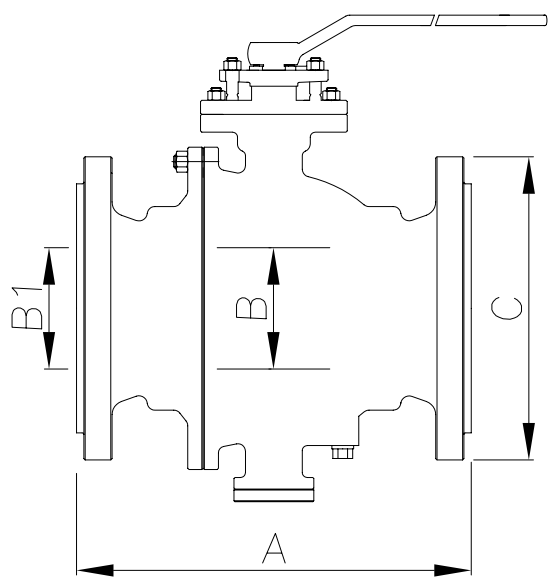

DESIGN CODE	API 6D/ANSI B16.34	TEST PRESSURES		
FACE TO FACE DIMENSIONS	ASME B16.10	BODY	153.1	Barg
ENDS FLANGES DIMENSIONS	ASME B16.5	SEAT	112.3	Barg
TESTING CODE	API 598	SEAT - AIR	6.0	Barg

REV	DATE	DESCRIPTION	BY	CHK	APP	SCALE:		
						DRAWN	DM	DATE
						CHECKED	SMN	DATE
						APPROVED	AW	DATE

DRAWING TITLE:
 API 6D, CARBON STEEL CLASS 600
 TRUNNION MOUNTED, RF, BALL VALVE

CLIENT:
 VENDOR PO REF:
 EVC REF:



Edmund
VALVE COMPANY (1965) LTD

CAD. No.	DRAWING NUMBER: 120018	REV
AREA No. 1	FACILITY	TYPE
SEQ. No.	SHT. No.	01

FIRE SAFE DESIGN TO API 607; TEST AND INSPECTION TO API 598; VALVES ARE IN ACCORDANCE WITH NACE MR-01-75 LATEST REV
 All drawings are subject to copyright, reproduction only with express permission of Edmund Valve Company (1965) Ltd. Subject to updating and revision.

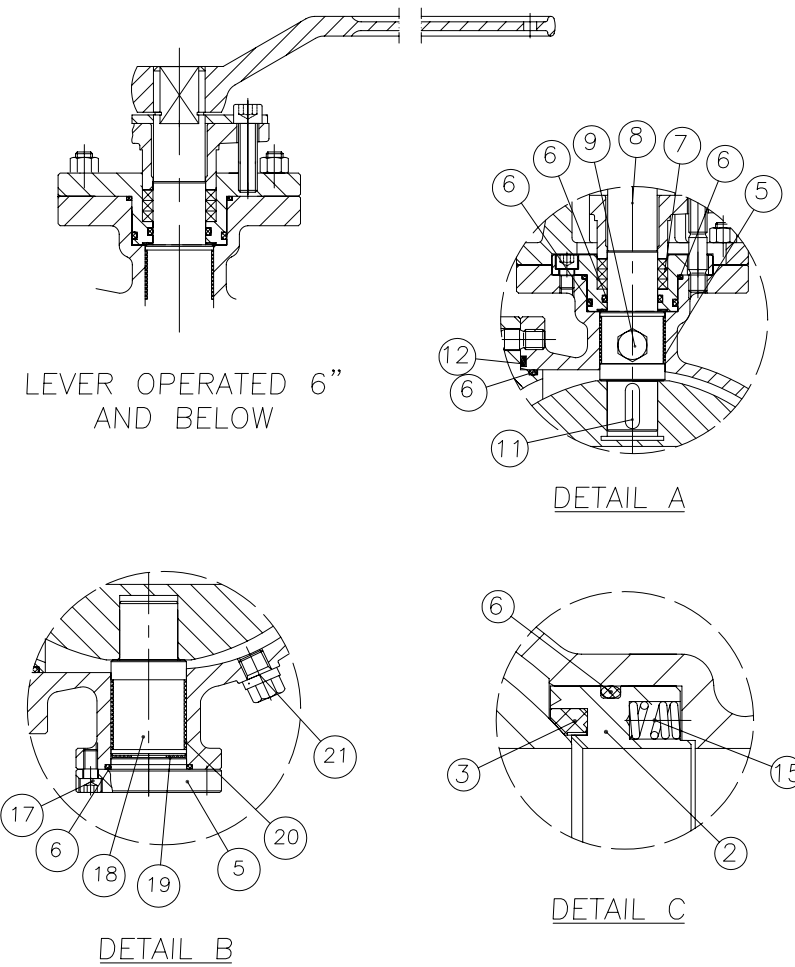
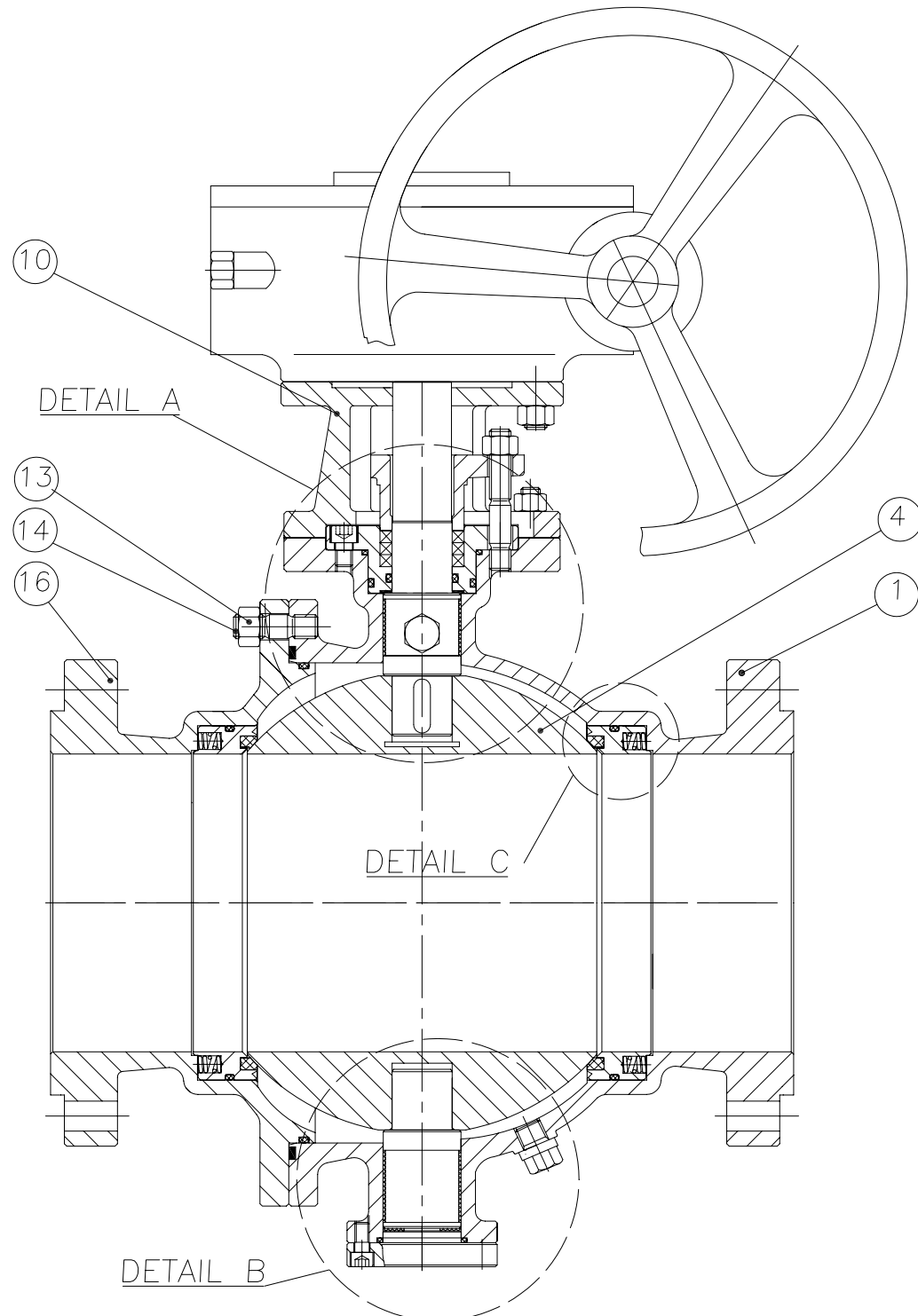

NO	PART NAME	MATERIAL	NOTES
21	DRAIN VALVE	AISI 1020+Zn	
20	BOTTOM COVER	ASTM A216 WCB/A105	
19	LOWER THRUST WASHER	PTFE	
18	FIXED SPINDLE	A182 F316	
17	SCREW	A193 GR.B7M	
16	BONNET/CLOSURE	ASTM A216 WCB	
15	SPRING	AISI 304 SS	
14	STUD	A193 GR.B7M	
13	NUTS	A194 GR.2HM	
12	GASKET	SS316+GRAPHITE	
11	KEY	A182 F316	
10	SUPPORT	ASTM A216 WCB	
9	VENT VALVE	AISI 1020+Zn	
8	STEM	A182 F316	
7	PACKING	PTFE	
6	O-RING	VITON	
5	SLIDING BEARING	PTFE/STAINLESS STEEL	
4	BALL	AISI 316 SS	
3	SEAT	NYLON	
2	SEAT CARRIER	A182 F316	
1	BODY	ASTM A216 WCB	

Size	A			B	B1	C
	RF	RTJ	WE			
2"	368	371	368	51	51	216
3"	381	384	381	77	77	241
4"	457	460	457	102	102	292
6"	610	613	610	152	152	381
8"	737	740	737	203	203	470
10"	838	841	838	254	254	544.5
12"	965	968	965	305	305	610
14"	1029	1038	1029	324	324	641.5
16"	1130	1140	1130	375	375	705
18"	1219	1232	1219	425	425	785
20"	1321	1333	1321	473	473	858
24"	1549	1568	1549	571.5	571.5	1042

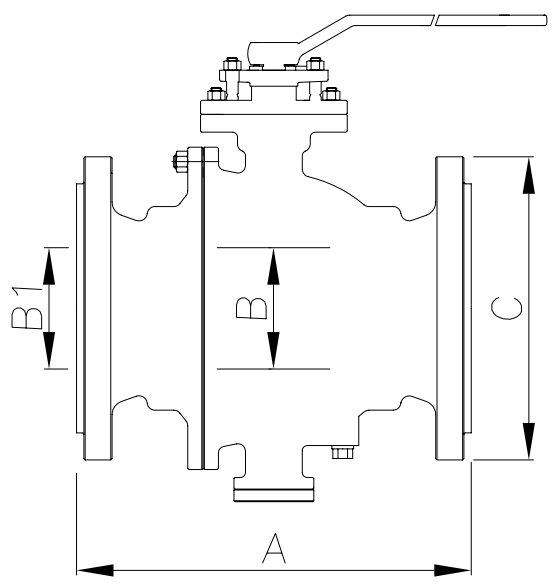

DESIGN CODE	API 6D/ANSI B16.34	TEST PRESSURES		
FACE TO FACE DIMENSIONS	ASME B16.10	BODY	229.8	Barg
ENDS FLANGES DIMENSIONS	ASME B16.5	SEAT	168.52	Barg
TESTING CODE	API 598	SEAT - AIR	6.0	Barg

REV	DATE	DESCRIPTION	BY	CHK	APP	SCALE:		
						DRAWN	DM	DATE
						CHECKED	SMN	DATE
						APPROVED	AW	DATE

DRAWING TITLE:
 API 6D, CARBON STEEL CLASS 900
 TRUNNION MOUNTED, RF, BALL VALVE

CLIENT:
 VENDOR PO REF:
 EVC REF:

CAD. No. DRAWING NUMBER: 120021 REV
 AREA No. 1 FACILITY TYPE SEQ. No. SHT. No. 01

FIRE SAFE DESIGN TO API 607; TEST AND INSPECTION TO API 598; VALVES ARE IN ACCORDANCE WITH NACE MR-01-75 LATEST REV
 All drawings are subject to copyright, reproduction only with express permission of Edmund Valve Company (1965) Ltd. Subject to updating and revision.

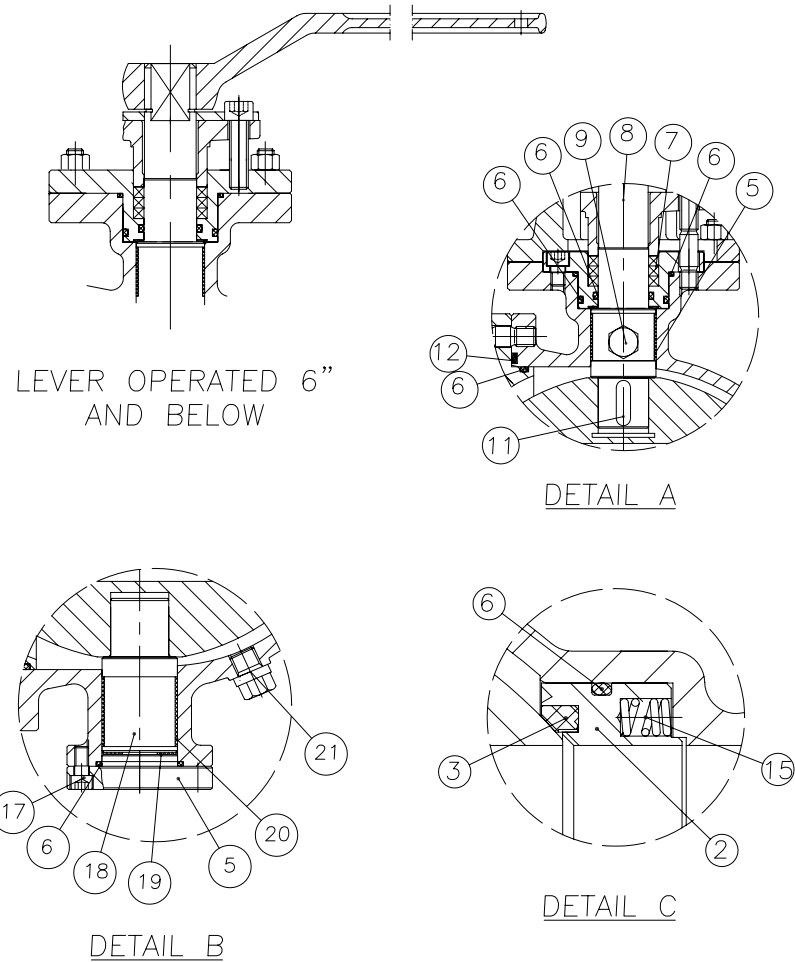
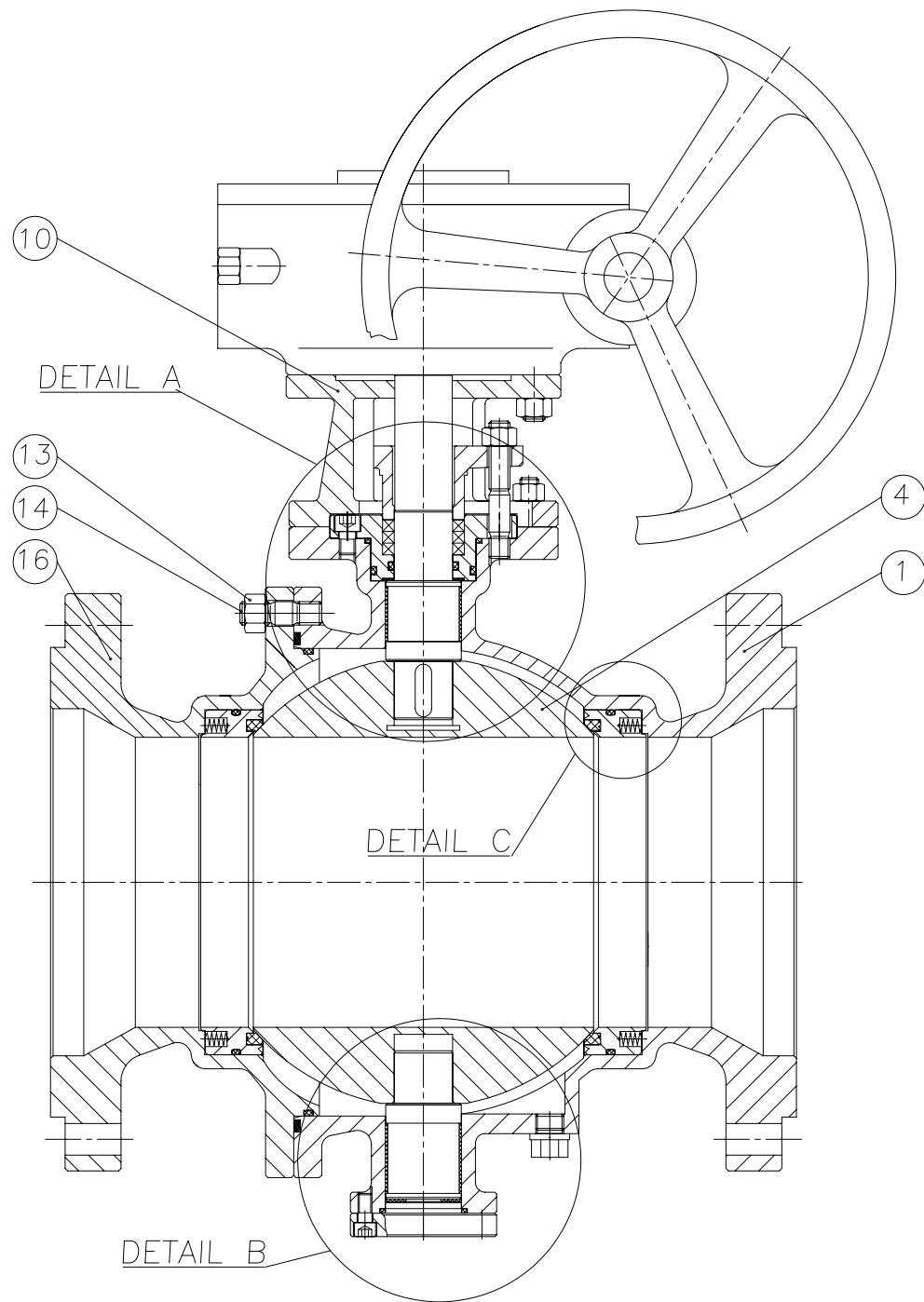

NO	PART NAME	MATERIAL	NOTES
21	DRAIN VALVE	AISI 1020+Zn	
20	BOTTOM COVER	ASTM A216 WCB/A105	
19	LOWER THRUST WASHER	PTFE	
18	FIXED SPINDLE	A182 F316	
17	SCREW	A193 GR.B7M	
16	BONNET/CLOSURE	ASTM A216 WCB	
15	SPRING	AISI 304 SS	
14	STUD	A193 GR.B7M	
13	NUTS	A194 GR.2HM	
12	GASKET	SS316+GRAPHITE	
11	KEY	A182 F316	
10	SUPPORT	ASTM A216 WCB	
9	VENT VALVE	AISI 1020+Zn	
8	STEM	A182 F316	
7	PACKING	PTFE	
6	O-RING	VITON	
5	SLIDING BEARING	PTFE/STAINLESS STEEL	
4	BALL	AISI 316 SS	
3	SEAT	RPTFE	
2	SEAT CARRIER	A182 F316	
1	BODY	ASTM A216 WCB	

Size	A			B	B1	C
	RF	RTJ	WE			
2"x1 1/2"	178	190	216	51	51	152
3"x2"	203	216	283	77	77	190
4"x3"	229	241	305	102	102	230
6"x4"	394	406	457	152	152	279.5
8"x6"	457	470	521	203	203	343
10"x8"	533	546	559	254	254	406
12"x10"	610	622	635	305	305	483
14"x12"	686	698	762	337	337	535
16"x14"	762	775	838	387	387	597
18"x16"	864	876	914	438	438	635
20"x16"	914	927	991	489	489	700
24"x20"	1067	1079	1143	591	591	813

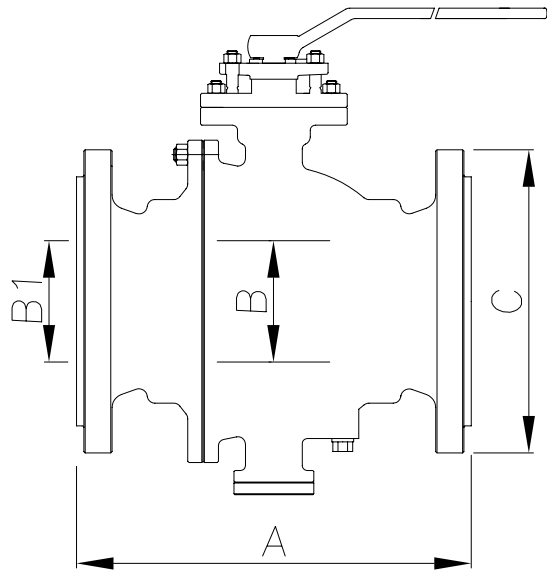

DESIGN CODE	API 6D/ANSI B16.34	TEST PRESSURES		
FACE TO FACE DIMENSIONS	ASME B16.10	BODY	29.4	Barg
ENDS FLANGES DIMENSIONS	ASME B16.5	SEAT	21.5	Barg
TESTING CODE	API 598	SEAT - AIR	6.0	Barg

REV	DATE	DESCRIPTION	BY	CHK	APP	SCALE:		
						DRAWN	DM	DATE
						CHECKED	SMN	DATE
						APPROVED	AW	DATE

DRAWING TITLE:
 API 6D, CARBON STEEL CLASS 150
 TRUNNION MOUNTED, RF, RB, BALL VALVE

CLIENT:

VENDOR PO REF:

EVC REF:

CAD. No. DRAWING NUMBER: 120042 REV
 AREA No. 1 FACILITY TYPE SEQ. No. SHT. No. 01

FIRE SAFE DESIGN TO API 607; TEST AND INSPECTION TO API 598; VALVES ARE IN ACCORDANCE WITH NACE MR-01-75 LATEST REV
 All drawings are subject to copyright, reproduction only with express permission of Edmund Valve Company (1965) Ltd. Subject to updating and revision.

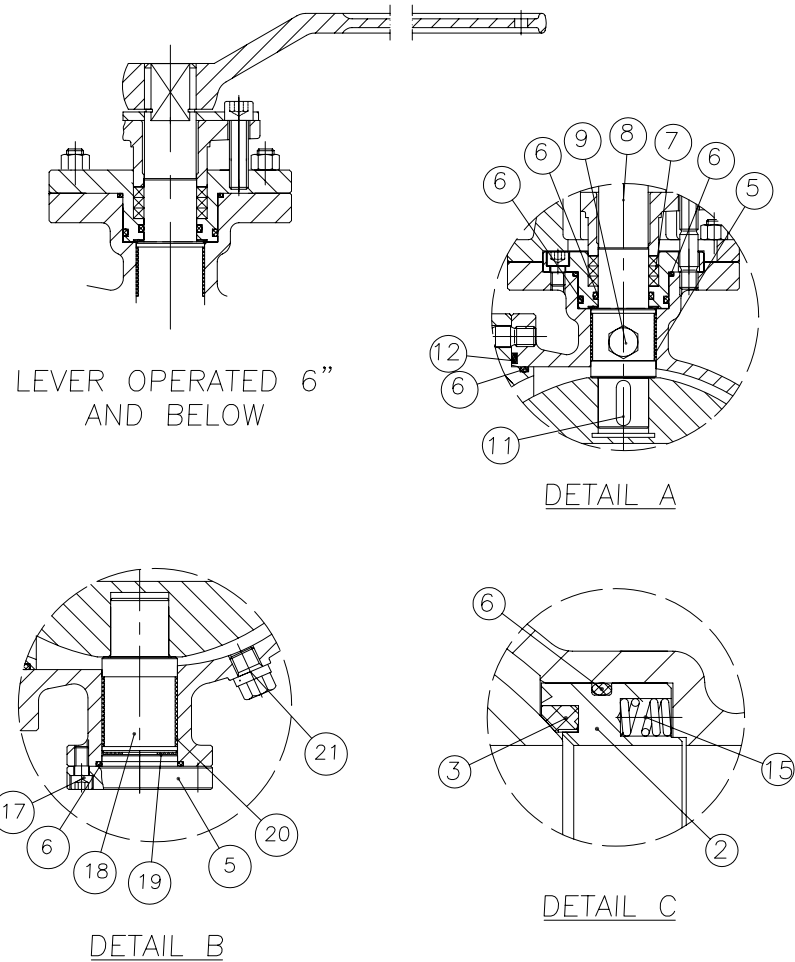
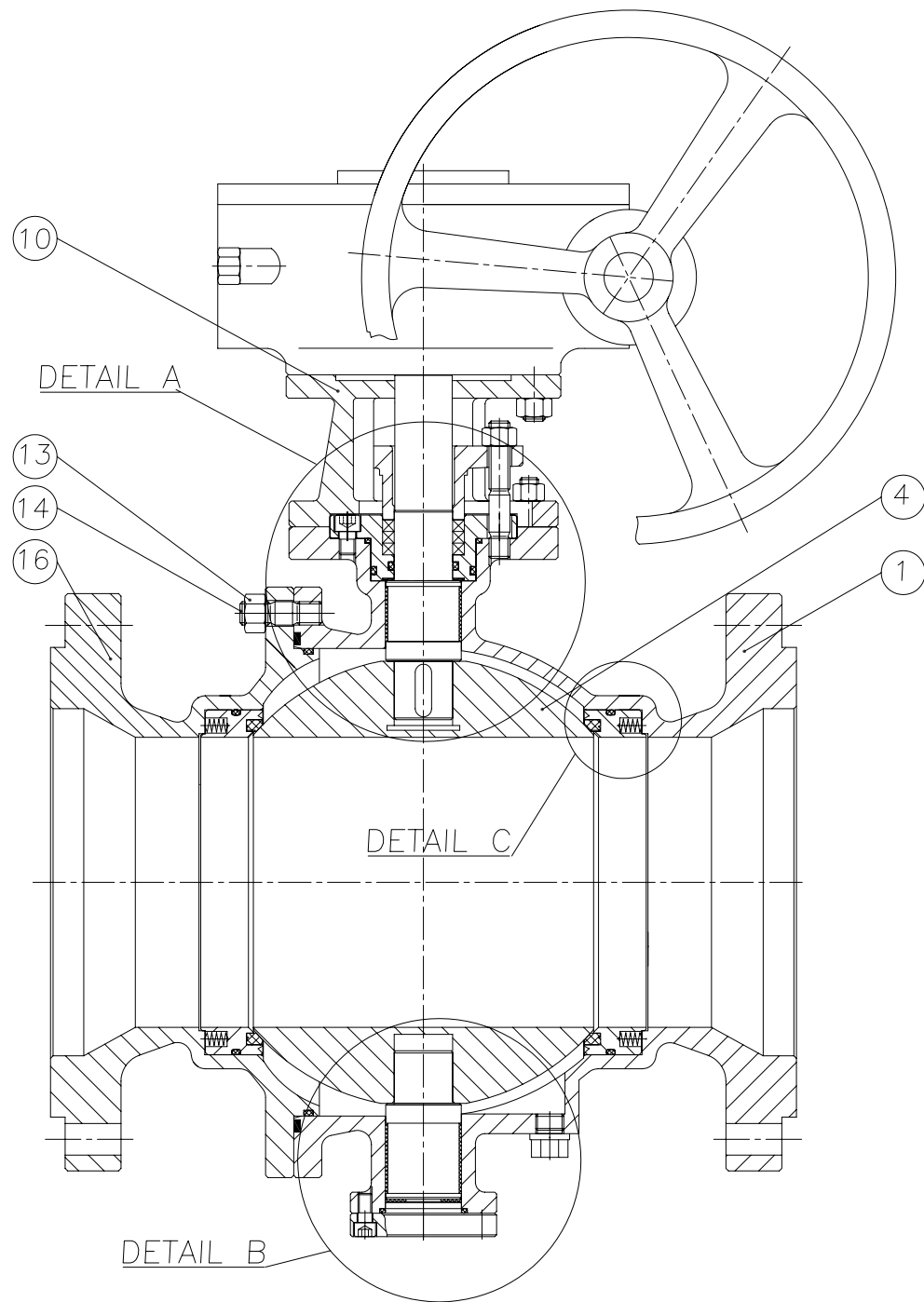

NO	PART NAME	MATERIAL	NOTES
21	DRAIN VALVE	AISI 1020+Zn	
20	BOTTOM COVER	ASTM A216 WCB/A105	
19	LOWER THRUST WASHER	PTFE	
18	FIXED SPINDLE	A182 F316	
17	SCREW	A193 GR.B7M	
16	BONNET/CLOSURE	ASTM A216 WCB	
15	SPRING	AISI 304 SS	
14	STUD	A193 GR.B7M	
13	NUTS	A194 GR.2HM	
12	GASKET	SS316+GRAPHITE	
11	KEY	A182 F316	
10	SUPPORT	ASTM A216 WCB	
9	VENT VALVE	AISI 1020+Zn	
8	STEM	A182 F316	
7	PACKING	PTFE	
6	O-RING	VITON	
5	SLIDING BEARING	PTFE/STAINLESS STEEL	
4	BALL	AISI 316 SS	
3	SEAT	RPTFE	
2	SEAT CARRIER	A182 F316	
1	BODY	ASTM A216 WCB	

Size	A			B	B1	C
	RF	RTJ	WE			
2"x1 1/2"	216	232	216	38	51	165
3"x2"	283	298	283	51	77	210
4"x3"	305	321	305	77	102	254
6"x4"	403	419	457	102	152	318
8"x6"	502	517	521	152	203	381
10"x8"	568	584	559	203	254	445
12"x10"	648	664	635	254	305	520
14"x12"	762	778	762	305	337	585
16"x14"	838	854	838	337	387	650
18"x16"	914	930	914	387	438	710
20"x16"	991	1010	991	387	489	775
24"x20"	1143	1165	1143	489	591	915

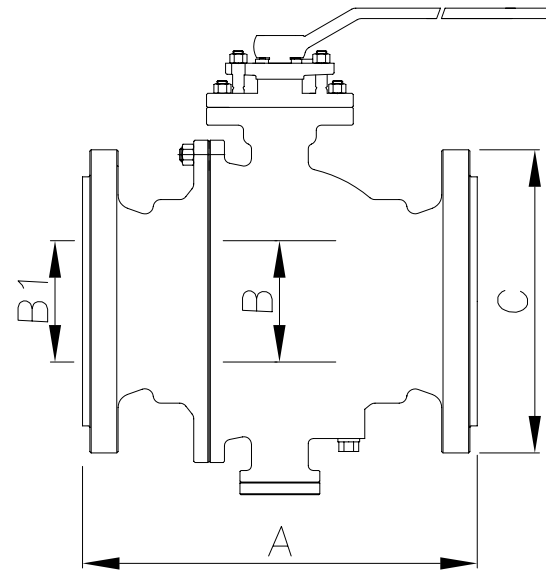

DESIGN CODE	API 6D/ANSI B16.34	TEST PRESSURES		
FACE TO FACE DIMENSIONS	ASME B16.10	BODY	76.0	Barg
ENDS FLANGES DIMENSIONS	ASME B16.5	SEAT	55.0	Barg
TESTING CODE	API 598	SEAT - AIR	6.0	Barg

REV	DATE	DESCRIPTION	BY	CHK	APP	SCALE:		
						DRAWN	DM	DATE
						CHECKED	SMN	DATE
						APPROVED	AW	DATE

DRAWING TITLE:
 API 6D, CARBON STEEL CLASS 300
 TRUNNION MOUNTED, RF, RB, BALL VALVE

CLIENT: .
 VENDOR PO REF: .
 EVC REF: .

CAD. No. . DRAWING NUMBER: 120043 REV
 AREA No. 1 FACILITY . TYPE . SEQ. No. . SHT. No. 01

FIRESAFE DESIGN TO API 607, TEST AND INSPECTION TO API 598 VALVES ARE IN ACCORDANCE WITH NACE MR-01-75 LATEST REV
 All drawings are subject to copyright, reproduction only with express permission. Subject to updating and revision.

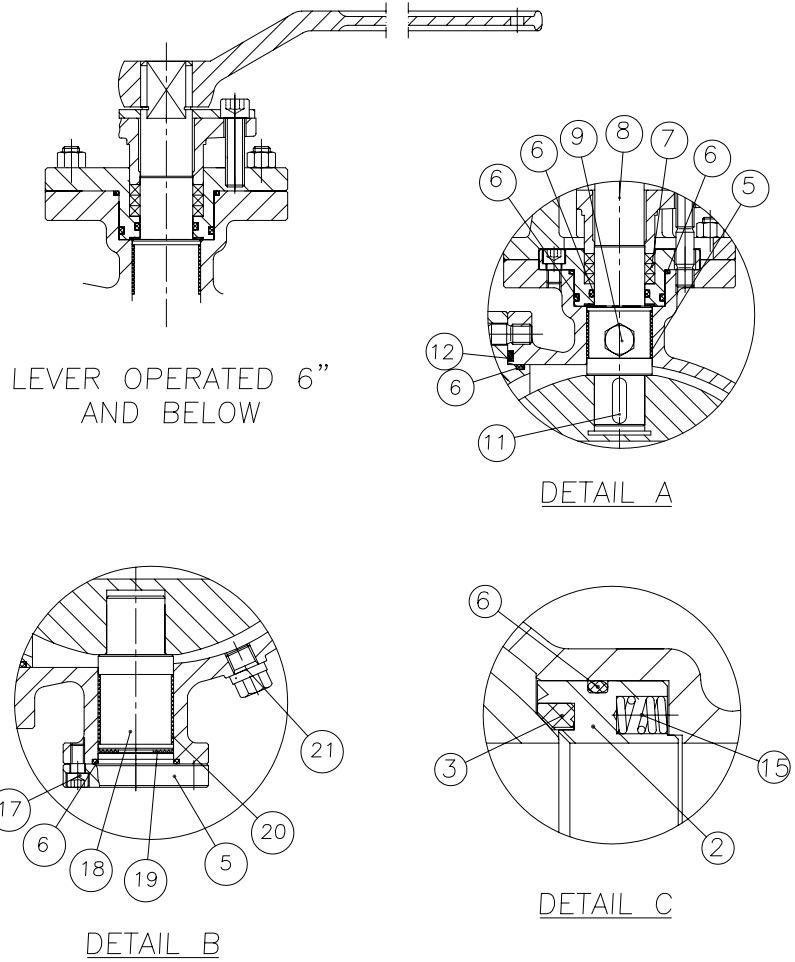
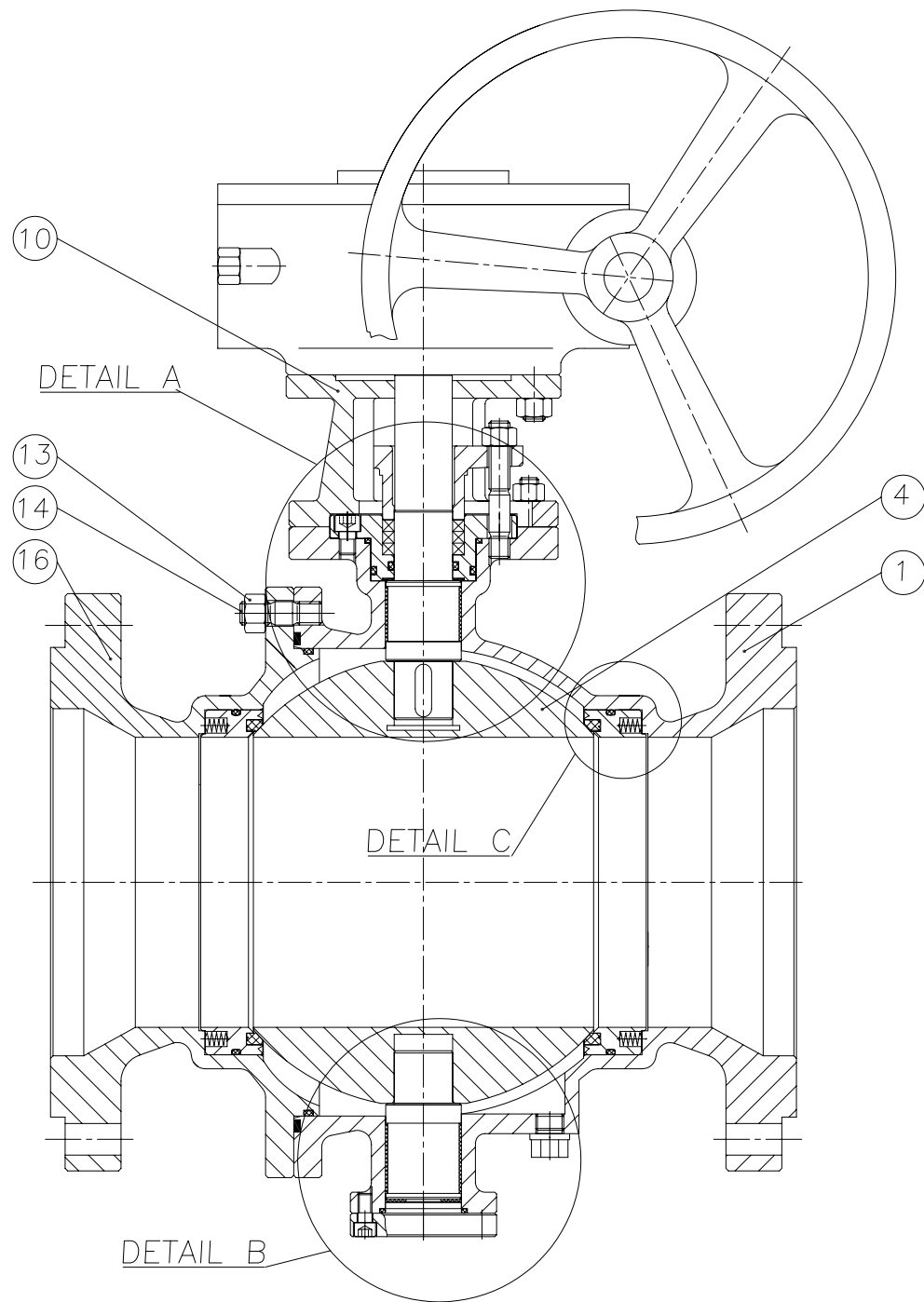

NO	PART NAME	MATERIAL	NOTES
21	DRAIN VALVE	AISI 1020+Zn	
20	BOTTOM COVER	ASTM A216 WCB/A105	
19	LOWER THRUST WASHER	PTFE	
18	FIXED SPINDLE	A182 F316	
17	SCREW	A193 GR.B7M	
16	BONNET/CLOSURE	ASTM A216 WCB	
15	SPRING	AISI 304 SS	
14	STUD	A193 GR.B7M	
13	NUTS	A194 GR.2HM	
12	GASKET	SS316+GRAPHITE	
11	KEY	A182 F316	
10	SUPPORT	ASTM A216 WCB	
9	VENT VALVE	AISI 1020+Zn	
8	STEM	A182 F316	
7	PACKING	PTFE	
6	O-RING	VITON	
5	SLIDING BEARING	PTFE/STAINLESS STEEL	
4	BALL	AISI 316 SS	
3	SEAT	NYLON	
2	SEAT CARRIER	A182 F316	
1	BODY	ASTM A216 WCB	

Size	A			B	B1	C
	RF	RTJ	WE			
2"x1 1/2"	292	295	292	38	51	165
3"x2"	356	359	356	51	77	210
4"x3"	432	435	432	77	102	273
6"x4"	559	562	559	102	152	356
8"x6"	660	664	660	152	203	419
10"x8"	787	791	787	203	254	510
12"x10"	838	841	838	254	305	559
14"x12"	889	892	889	305	337	605
16"x14"	991	994	991	337	387	685
18"x16"	1092	1095	1092	387	438	745
20"x18"	1194	1200	1194	438	489	815
24"x20"	1397	1406	1397	489	591	940

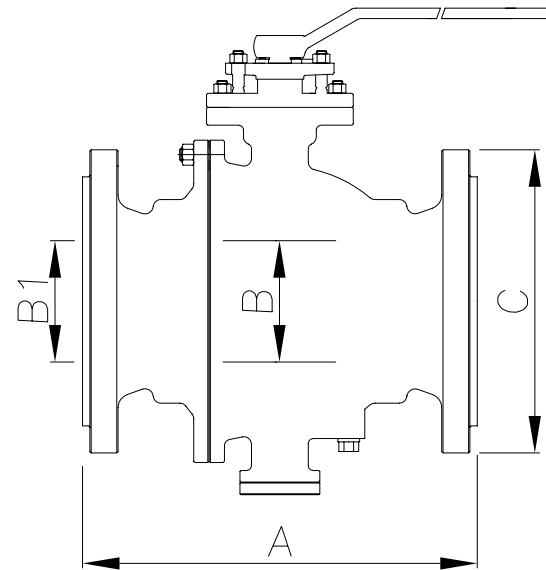

DESIGN CODE	API 6D/ANSI B16.34	TEST PRESSURES		
FACE TO FACE DIMENSIONS	ASME B16.10	SHELL	153.1	Barg
ENDS FLANGES DIMENSIONS	ASME B16.5	SEAT	112.3	Barg
TESTING CODE	API 598	AIR	6.0	Barg

REV	DATE	DESCRIPTION	BY	CHK	APP	SCALE:		
						DRAWN	DM	DATE
						CHECKED	SMN	DATE
						APPROVED	AW	DATE

DRAWING TITLE:
 API 6D, CARBON STEEL CLASS 600
 TRUNNION MOUNTED, RF, RB, BALL VALVE

CLIENT:

VENDOR PO REF:

EVC REF:

CAD. No. DRAWING NUMBER: 120044 REV
 AREA No. 1 FACILITY TYPE SEQ. No. SHT. No. 01

FIRESAFE DESIGN TO API 607, TEST AND INSPECTION TO API 598 VALVES ARE IN ACCORDANCE WITH NACE MR-01-75 LATEST REV
 All drawings are subject to copyright, reproduction only with express permission. Subject to updating and revision.

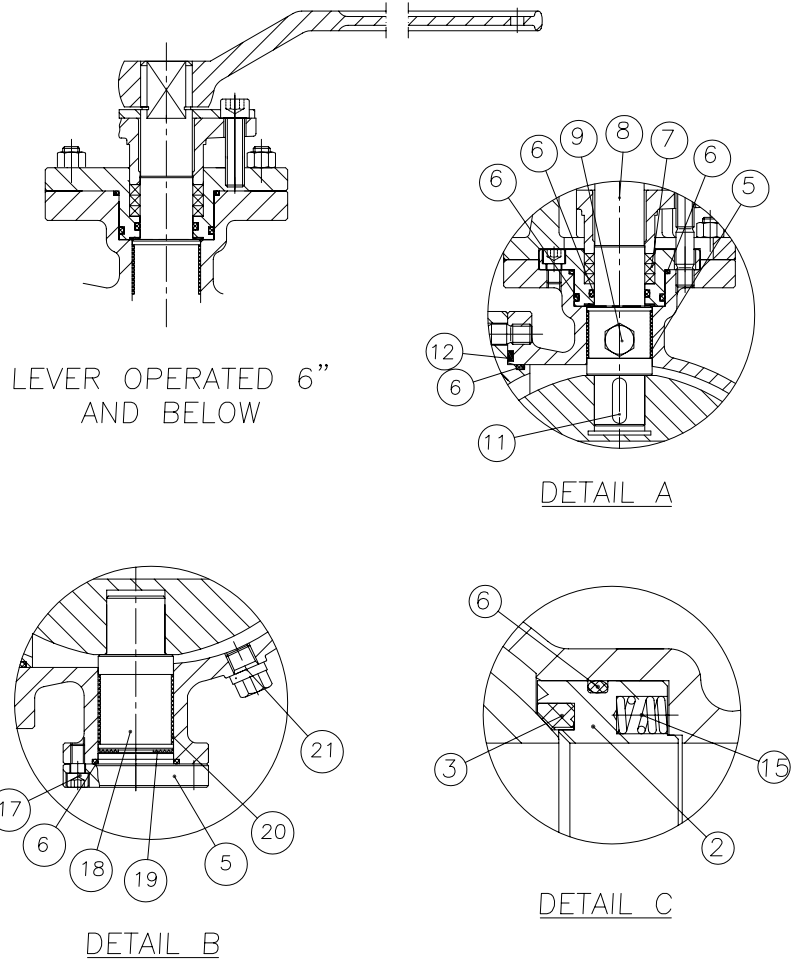
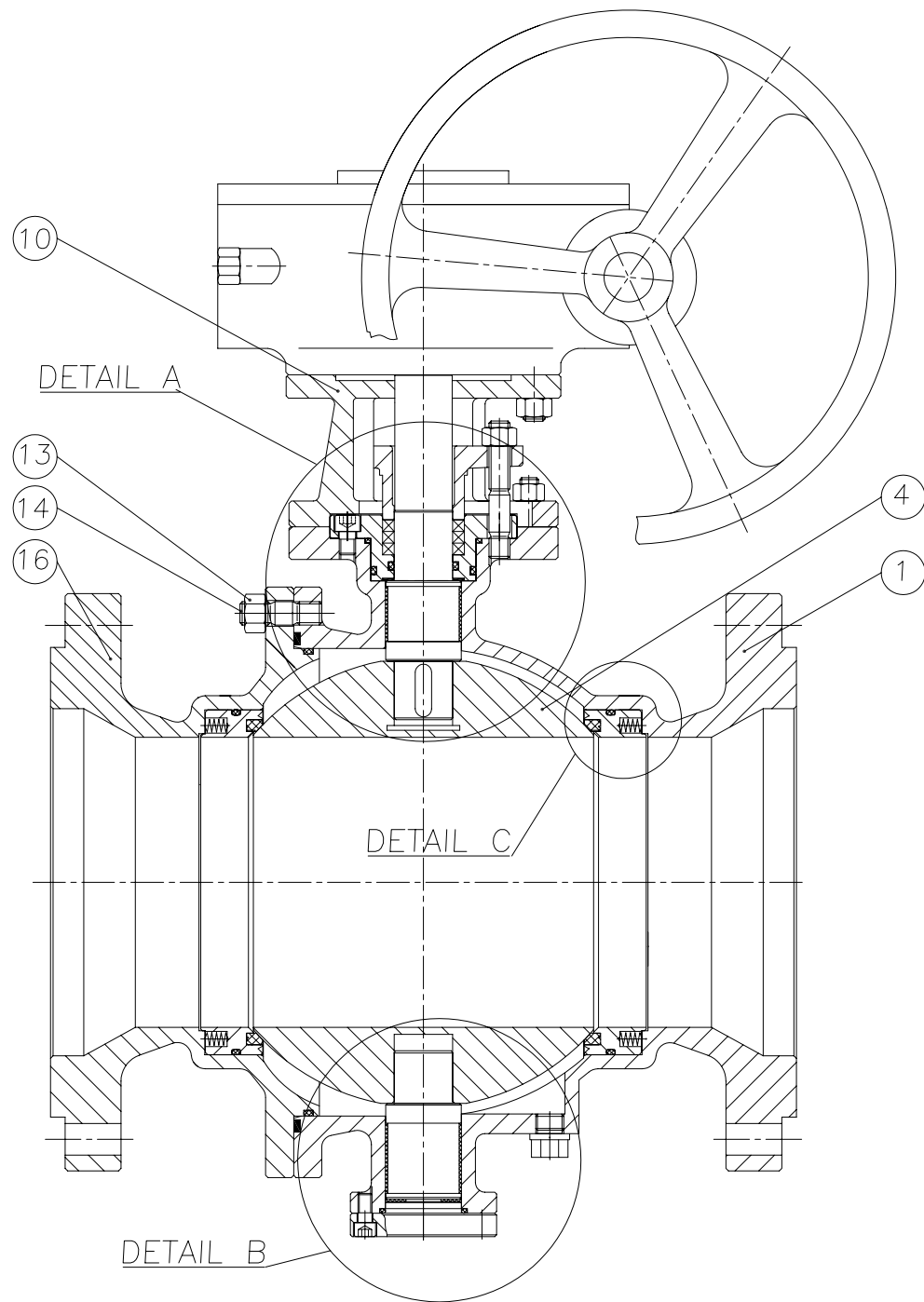

NO	PART NAME	MATERIAL	NOTES
21	DRAIN VALVE	AISI 1020+Zn	
20	BOTTOM COVER	ASTM A216 WCB/A105	
19	LOWER THRUST WASHER	PTFE	
18	FIXED SPINDLE	A182 F316	
17	SCREW	A193 GR.B7M	
16	BONNET/CLOSURE	ASTM A216 WCB	
15	SPRING	AISI 304 SS	
14	STUD	A193 GR.B7M	
13	NUTS	A194 GR.2HM	
12	GASKET	SS316+GRAPHITE	
11	KEY	A182 F316	
10	SUPPORT	ASTM A216 WCB	
9	VENT VALVE	AISI 1020+Zn	
8	STEM	A182 F316	
7	PACKING	PTFE	
6	O-RING	VITON	
5	SLIDING BEARING	PTFE/STAINLESS STEEL	
4	BALL	AISI 316 SS	
3	SEAT	NYLON	
2	SEAT CARRIER	A182 F316	
1	BODY	ASTM A216 WCB	

Size	A			B	B1	C
	RF	RTJ	WE			
2"x1 1/2"	368	371	368	38	51	216
3"x2"	381	384	381	51	77	241
4"x3"	457	460	457	77	102	292
6"x4"	610	613	610	102	152	381
8"x6"	737	740	737	152	203	470
10"x8"	838	841	838	203	254	546.5
12"x10"	965	968	965	254	305	610
14"x12"	1029	1038	1029	305	324	641.5
16"x14"	1130	1140	1130	324	375	705
18"x16"	1219	1232	1219	375	425	785
20"x18"	1321	1333	1321	425	473	855
24"x20"	1549	1568	1549	473	571.5	1042

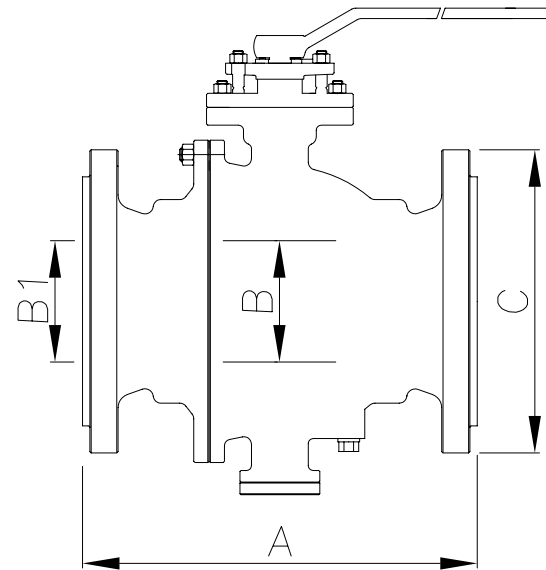

DESIGN CODE	API 6D/ANSI B16.34	TEST PRESSURES		
FACE TO FACE DIMENSIONS	ASME B16.10	SHELL	229.8	Barg
ENDS FLANGES DIMENSIONS	ASME B16.5	SEAT	168.52	Barg
TESTING CODE	API 598	AIR	6.0	Barg

REV	DATE	DESCRIPTION	BY	CHK	APP	SCALE:		
						DRAWN	DM	DATE
						CHECKED	SMN	DATE
						APPROVED	AW	DATE

DRAWING TITLE:
 API 6D, CARBON STEEL CLASS 900
 TRUNNION MOUNTED, RF, RB, BALL VALVE

CLIENT:

VENDOR PO REF:

EVC REF:

CAD. No. DRAWING NUMBER: 120045 REV
 AREA No. 1 FACILITY TYPE SEQ. No. SHT. No. 01