



# Edmund

VALVE COMPANY (1965) LTD

# KNIFE GATE VALVES



Edmund

# KNIFE GATE VALVE SERIES



**Chief Features**

- Face-to-face dimensions adopt short series, and light weight valve is adopted, so as to save pipe supporter.
- During the opening and closing of the valve, the gate disc can automatically scrape off the adhered medium and is beneficial to sealing.
- The blade type gate disc helps medium cutoff and residue discharge so that the valve can be operated without blocking.
- The valve adopts water type connection.
- The wedge type limit stopper can provide sealing force, reliable sealing
- The guide nail can provide good guiding function.
- The anti-abrasive bushings of different materials can be provided according to requirements so as to prolong the service life of the valve.
- Actuators (electric, gear box, pneumatic,hydraulic)can be freely selected.

**Product Specification**

Design Spec.	Face to Face	Flange End	Test & Check	Marking	Supply
MSS SP-81	MSS SP-81	ASME B16.5	MSS SP-81	MSS SP-25	MSS SP-81

**Main Part Material**

Main Body Material Code		Part Name
Carbon steel/Stainless steel		Body/Bonnet
Stainless steel	S.S	Disc
Stainless steel	S.S	Stem
Rubber/PTFE/Graphite	ASB/PTFE/Graphite	Packing
-29℃~+425℃		Suitable Temp.
paper pulp、Mixtureof sewage、coal slurry、ash and seriflux		Suitable Medium

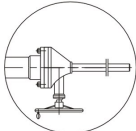

Bevel gear

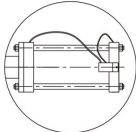

Pneumatic

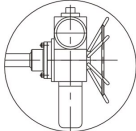

Electric

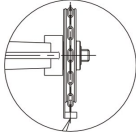

Sprocket wheel

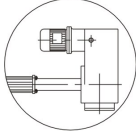

Electric-hydraulic

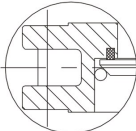
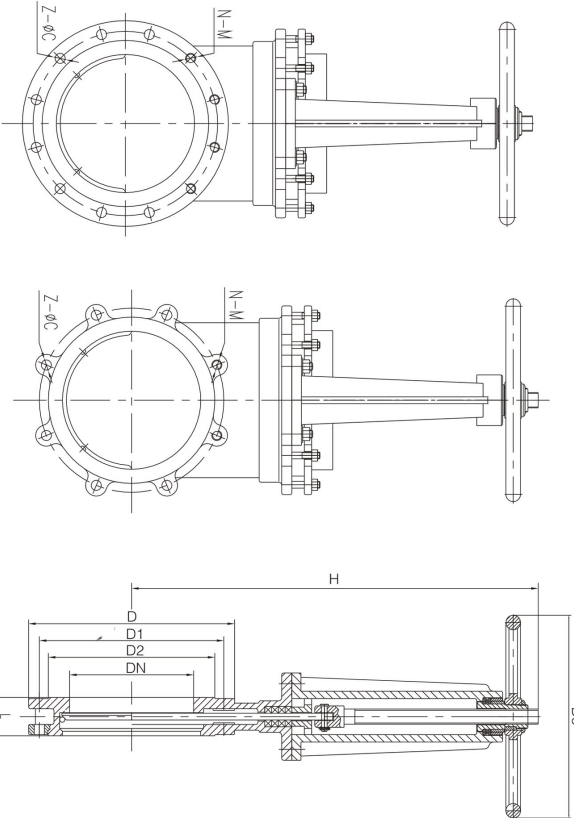

Soft seal

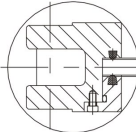

Double-direction soft seal

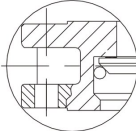

Hard seal

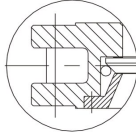

PHard seal with Deflector

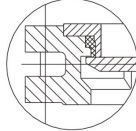

Flexible seal

## Main External and Connection Dimension(ASME B16.5)

DN	Class 150Lb						Unit: mm
	L	D	D <sub>1</sub>	D <sub>2</sub>	N-M	Z-φ d	
2	48	152	120.5	92	2-M16	2-φ 18	285
2-1/2	48	178	139.5	105	2-M16	2-φ 18	295
3	51	190	152.5	127	2-M16	2-φ 18	315
4	51	229	190.5	157	2-M16	6-φ 18	365
5	57	254	216	186	2-M20	6-φ 22	400
6	57	279	241.5	216	2-M20	6-φ 22	475
8	70	343	298.5	270	2-M20	6-φ 22	540
10	70	406	362	324	4-M22	8-φ 25	630
12	76	480	432	381	4-M22	8-φ 25	780
14	76	533	476	413	4-M27	8-φ 30	885
16	89	597	540	470	6-M27	10-φ 30	990
18	89	635	578	533	6-M30	10-φ 33	1100
20	114	699	635	584	8-M30	12-φ 33	1200
24	114	813	749.5	692	8-M33	12-φ 36	1450
30	117	985	914	857	12-M33	16-φ 36	1950
36	117	1170	1086	1022	14-M39	18-φ 42	2450

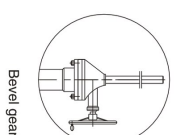

Bevel gear

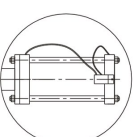

Pneumatic

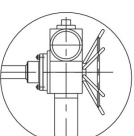

Electric

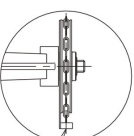

Sprocket wheel

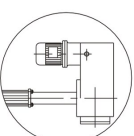

Electric-hydraulic

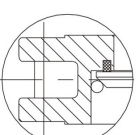
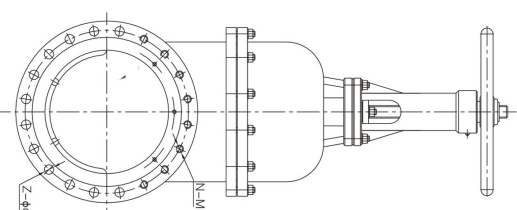
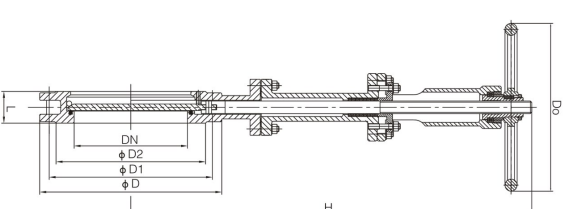

Soft seal

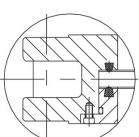

Double-direction soft seal

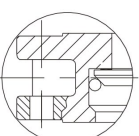

Hard seal

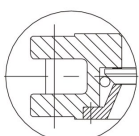

Phrad seal with Deflector

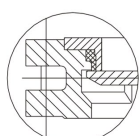

Flexible seal

**Main External and Connection Dimension(ASME B16.5)**

Unit: mm

DN	Class 150Lb						WT (kg)
	L	D	D <sub>1</sub>	D <sub>2</sub>	N-M	Z-φ d	
2	43	152	120.5	92	2-M16	2-φ 19	365
2-1/2	43	178	139.5	105	2-M16	2-φ 19	400
3	46	190	152.5	127	2-M16	2-φ 19	475
4	52	229	190.5	157	2-M16	6-φ 19	540
5	56	254	216	186	2-M20	6-φ 23	630
6	56	279	241.5	216	2-M20	6-φ 23	780
8	60	343	298.5	270	2-M20	6-φ 23	885
10	68	406	362	324	4-M22	8-φ 25	990
12	78	480	432	381	4-M22	8-φ 25	1100
14	78	533	476	413	4-M27	8-φ 30	1200
16	102	597	540	470	6-M27	10-φ 30	1450
18	114	635	578	533	6-M30	10-φ 30	1650
20	127	699	635	584	8-M30	12-φ 30	1900
24	154	813	749.5	692	8-M33	12-φ 30	2100
30	165	985	914	857	8-M33	12-φ 30	2600
36	203	1170	1086	1022	14-M39	18-φ 42	3200

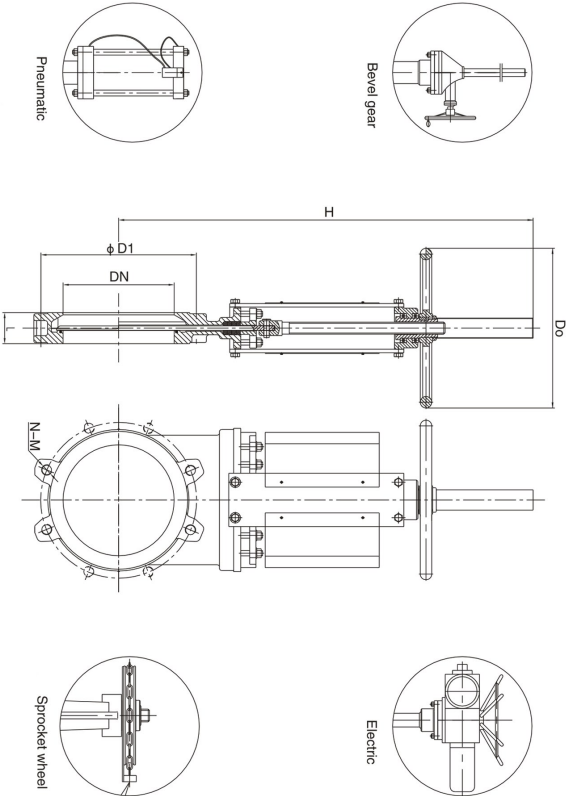

**Main External and Connection Dimension**

Unit: mm

DN	PN1.0MPa					WT (kg)
	L	D	D <sub>1</sub>	D <sub>2</sub>	N-M	
50	46	165	125	102	4-M16	285
65	46	180	145	120	4-M16	350
80	51	195	160	135	4-M16	467
100	51	215	180	155	8-M16	550
125	57	245	210	185	8-M16	605
150	60	280	240	210	8-M20	645
200	60	335	295	265	8-M20	840
250	70	390	350	320	12-M20	1015
300	78	440	400	368	12-M20	1165
350	78	500	460	428	16-M20	1345
400	102	565	515	482	16-M22	1495
450	114	615	565	532	20-M22	1650
500	127	670	620	585	20-M22	1805

### Main External and Connection Dimension(ASME B16.5)

DN	Class 150Lb						WT (kg)
	L	D	D <sub>1</sub>	D <sub>2</sub>	N-M	Z-φ d	H
2	43	152	120.5	92	2-M16	2-φ 19	365
2-1/2	43	178	139.5	105	2-M16	2-φ 19	400
3	46	190	152.5	127	2-M16	2-φ 19	475
4	52	229	190.5	157	2-M16	6-φ 19	540
5	56	254	216	186	2-M20	6-φ 23	630
6	56	279	241.5	216	2-M20	6-φ 23	780
8	60	343	298.5	270	2-M20	6-φ 23	885
10	68	406	362	324	4-M22	8-φ 25	990
12	78	480	432	381	4-M22	8-φ 25	1100
14	78	533	476	413	4-M27	8-φ 30	1200
16	102	597	540	470	6-M27	10-φ 30	1450
18	114	635	578	533	6-M30	10-φ 30	1650
20	127	699	635	584	8-M30	12-φ 30	1900
24	154	813	749.5	392	8-M33	12-φ 30	2100
30	165	985	914	857	8-M33	12-φ 30	2600
36	203	1170	1086	1022	14-M39	18-φ 42	3200

Unit: mm

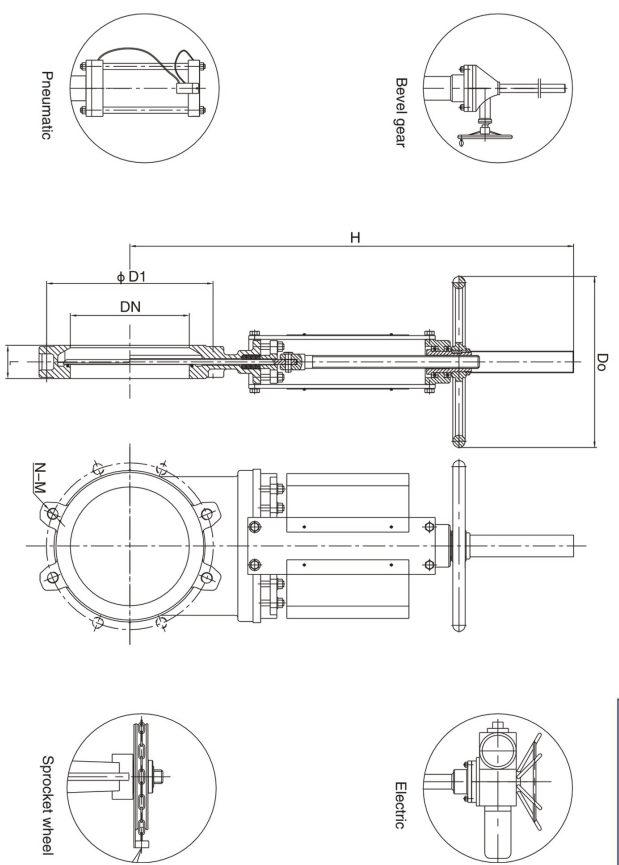

### Main External and Connection Dimension

DN	PN1.0MPa						WT (kg)
	L	D	D <sub>1</sub>	D <sub>2</sub>	N-M	D <sub>0</sub>	H
50	46	165	125	102	4-M16	200	285
65	46	180	145	120	4-M16	200	350
80	51	195	160	135	4-M16	200	467
100	51	215	180	155	8-M16	220	550
125	57	245	210	185	8-M16	240	605
150	60	280	240	210	8-M20	280	645
200	60	335	295	265	8-M20	320	840
250	70	390	350	320	12-M20	360	1015
300	78	440	400	368	12-M20	360	1165
350	78	500	460	428	16-M20	400	1345
400	102	565	515	482	16-M22	500	1495
450	114	615	565	532	20-M22	500	1650
500	127	670	620	585	20-M22	600	1805

Unit: mm

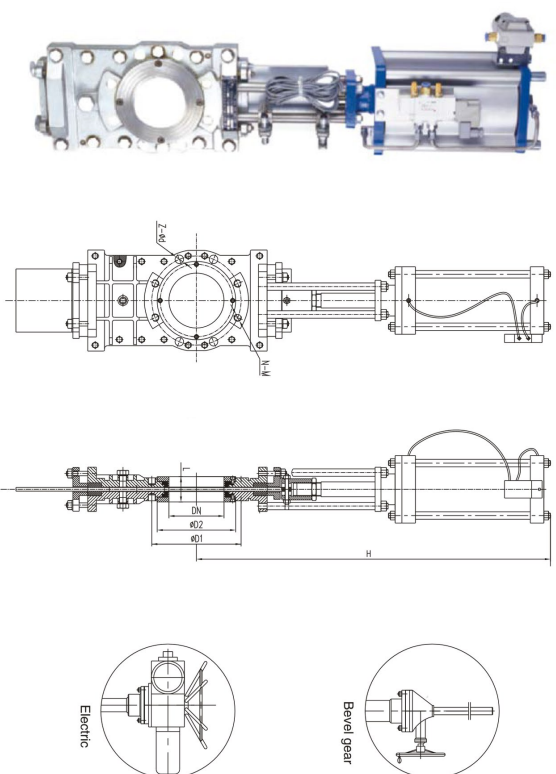

Main External and Connection Dimension								Unit: mm
DN	PN1.0MPa							WT (kg)
	L	D	D <sub>1</sub>	D <sub>2</sub>	Z-φd	N-M	H	
50	50	160	125	100		4-M16	397	11
65	50	180	145	120		4-M16	418	12
80	52	195	160	135		4-M16	560	14
100	66	215	180	155	4-φ18	4-M16	602	16
125	66	245	210	185	4-φ18	4-M16	690	17
150	74	280	240	210	4-φ23	4-M20	927	24
200	74	335	295	265	4-φ23	4-M20	1025	28
250	80	390	350	320	4-φ23	8-M20	1025	35
300	80	440	400	368	4-φ23	8-M20	1253	65
350	80	500	460	428	4-φ25	12-M22	1325	85
400	120	565	515	482	4-φ25	12-M22	1420	125

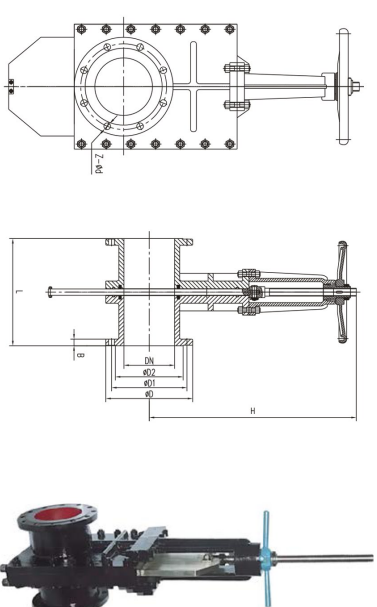

Main External and Connection Dimension									Unit: mm	
DN	PN1.0MPa								WT (kg)	
	L	D	D <sub>1</sub>	D <sub>2</sub>	Z-φd	b	H	D <sub>0</sub>		
100	300	215	180	155	8-φ18	20	470	220	65	
150	350	280	240	210	8-φ23	24	650	280	82	
200	420	335	295	265	8-φ23	26	810	280	120	
250	450	390	350	320	12-φ23	28	1060	350	230	
300	500	440	400	368	12-φ23	28	1450	350	373	
350	550	500	460	428	16-φ23	30	1765	400	512	
400	600	565	515	482	16-φ25	32	1950	500	690	
450	650	615	565	532	20-φ25	32	2090	500	736	
500	700	670	620	585	20-φ25	34	2120	600	815	

Main External and Connection Dimension										Unit: mm	
DN	PN1.6MPa									WT (kg)	
	L	D	D <sub>1</sub>	D <sub>2</sub>	Z-φd	b	H	D <sub>0</sub>			
100	300	215	180	155	8-φ18	20	470	220	65		
150	350	280	240	210	8-φ23	24	650	280	82		
200	420	335	295	265	12-φ23	26	810	280	120		
250	450	405	355	320	12-φ25	30	1060	350	230		
300	500	460	410	375	12-φ25	30	1450	350	373		
350	550	520	470	435	16-φ25	34	1765	400	512		
400	600	580	525	485	16-φ30	36	1950	500	690		
450	650	640	585	545	20-φ30	40	2090	500	736		
500	700	705	650	608	20-φ34	44	2120	600	815		

Main External and Connection Dimension									Unit: mm	
DN	PN2.5MPa								WT (kg)	
	L	D	D <sub>1</sub>	D <sub>2</sub>	Z-φd	b	H	D <sub>0</sub>		
100	300	230	190	160	8-φ23	24	470	220	65	
150	350	300	250	218	8-φ25	30	650	280	82	
200	420	360	310	278	12-φ25	34	810	280	120	
250	450	425	370	332	12-φ30	36	1060	350	230	
300	500	485	430	390	16-φ30	40	1450	350	373	
350	550	550	490	448	16-φ34	44	1765	400	512	
400	600	610	550	505	16-φ34	48	1950	500	690	
450	650	660	600	555	20-φ34	50	2090	500	736	
500	700	730	660	610	20-φ41	52	2120	600	815	

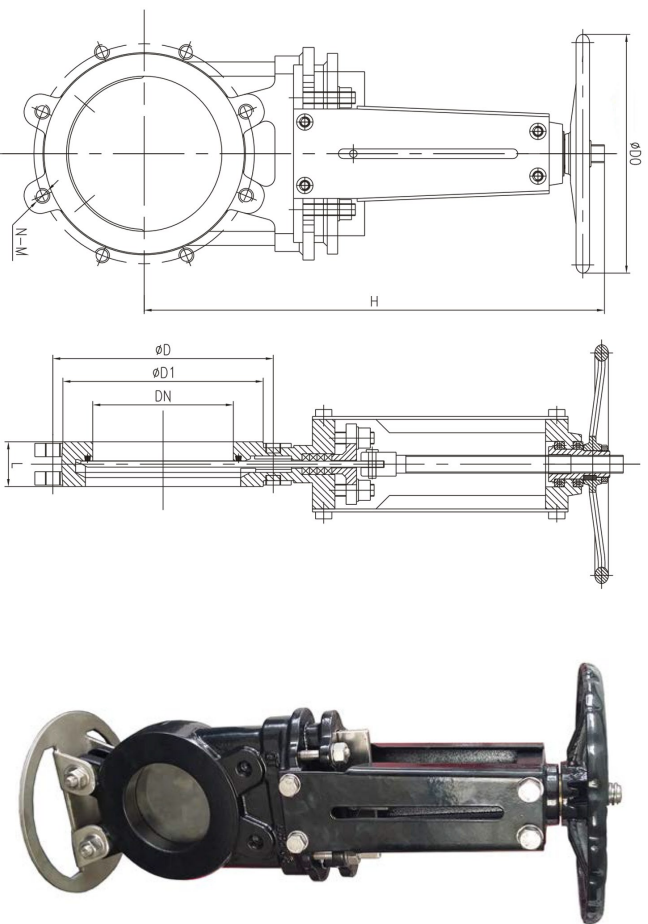

**Main External and Connection Dimension(ASME B16.5)**

Main External and Connection Dimension(ASME B16.5)								Unit: mm
DN	PN1.0MPa						WT (kg)	
	L	D	D <sub>2</sub>	N-M	D <sub>0</sub>	H		
50	40	125	100	4-M16	200	312	8	
65	40	145	120	4-M16	200	355	9.5	
80	50	160	135	8-M16	200	363	13	
100	50	180	155	8-M16	220	406	15	
125	50	210	185	8-M16	240	456	24	
150	60	240	210	8-M20	280	517	26.5	
200	60	295	265	8-M20	320	616	40	
250	70	350	320	12-M20	360	775	78	
300	70	400	368	12-M20	360	879	80	
350	96	460	428	16-M20	400	1015	205	
400	100	515	482	16-M22	500	1115	265	
450	106	565	532	20-M22	500	1218	315	
500	110	620	585	20-M22	600	1325	385	
600	110	725	685	20-M27	600	1456	435	

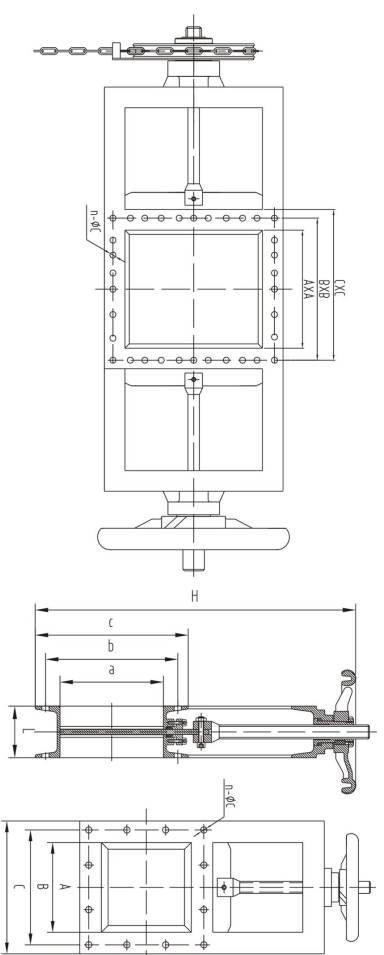

**Main External and Connection Dimension**

category	A × A	B × B	C × C	H	L	Z-φ d	WT (kg)
Single direction	200 × 200	256 × 256	296 × 296	820	100	8-φ 12	62
	250 × 250	306 × 306	346 × 346	930	100	8-φ 14	70.5
	300 × 300	356 × 356	396 × 396	1050	100	8-φ 14	81
	400 × 400	456 × 456	496 × 496	1240	100	12-φ 14	114
	450 × 450	510 × 510	556 × 556	1450	120	12-φ 18	130
	500 × 500	560 × 560	606 × 606	1610	120	16-φ 18	147
	600 × 600	660 × 660	706 × 706	1830	120	16-φ 18	169
	700 × 700	770 × 770	820 × 820	2130	140	20-φ 18	236
	800 × 800	870 × 870	920 × 920	2440	140	20-φ 18	303
	900 × 900	974 × 974	1030 × 1030	2660	160	24-φ 23	424
double direction	1000 × 1000	1074 × 1074	1130 × 1130	2870	160	24-φ 23	636
Instruction	LMD-Single direction	I-handwheel					
	LMS-double direction	II-handwheel					

**EVC**  
**Edmund**  
**VALVE COMPANY (1965) LTD**

UNIT 20E SPRINGVALE INDUSTRIAL ESTATE  
CWMBRAN  
NP44 5BA  
UNITED KINGDOM

TEL : 01633 867935

EMAIL: [SALES@EDMUNDVALVE.COM](mailto:SALES@EDMUNDVALVE.COM)

